

AVATAR™
DIESEL MOTORHOME



MOTORHOMES BY JAYCO®

2003



2003 AVATAR Standard and Optional Features

EXTERIOR

Standard

- Seamless Exterior Trunk Construction
- Lighted Exterior Pass-Through Trunks
- Fiberglass Baggage Doors with Slam Latches and Gas Struts (Except on LP Door)
- Rear Mud Flaps
- Rear Ladder
- Docking Lights
- Exclusive Design Frameless Windows
- Outside Utility Center with Shower
- Front and Rear Fiberglass End Caps
- High-Gloss Fiberglass Sidewalls
- One-Piece Seamless Crowned Fiberglass Roof
- Fog Lights
- Running Lights
- Hydraulic Automatic Leveling Jacks
- 10,000 Lb. Trailer Hitch
- Power, Remote, Heated Chrome Exterior Mirrors
- Exterior Vinyl Graphics, Three Choices*
- 7-Way Plug Pre-Wired for Brake Controller

Optional

- Window Awning(s)
- Slide-out Awning(s)
- Awning Over Entrance Door
- Patio Awning with Cover
- 12V Electric Patio Awning with Remote Control and Cover
- Spotlight with Remote
- Framed Thermal Pane Windows
- Full Width Deluxe Mud Flap
- Slide-Out Storage Trays (Single or Double)
- Front Cap Protective Film
- Full Body Paint, Four Choices*

CAB AREA

Standard

- 6-Way Power Ultraleather™ Driver Seat with Lumbar Support
- Ultraleather™ Passenger Seat
- Power Steering Smart Wheel
- Rearview Monitor System
- AM/FM Stereo with Cassete and CD Player
- Automotive Style ABS and Vinyl Wrapped Dash
- Driver and Passenger Sun Visors
- Above-Dash TV Cabinet with 27-inch TV
- Built-in Passenger Computer Workstation
- Interior Assist Handle
- Front Privacy Pleated Drapes
- Dash Mounted Digital Compass and Outside Thermometer
- Pilot and Co-Pilot Map Lights
- Fog Lights
- Intermittent Windshield Wipers
- Electric Step Well Cover
- 3-Way Dash-Mounted Generator Switch

Optional

- Air Horns
- Ultraleather™ 6-Way Power Passenger Seat
- CB Radio Prep with Antenna

CAB AREA (Cont.)

Optional

- GPS Navigation System
- Driver Sun Shade

INTERIOR/DECOR

Standard

- North Ridge Maple Cabinetry with Raised Panel Doors, Brass Hardware and Hidden Hinges
- Overhead Cabinets in Slide-Out Room
- Pleated Day/Night Shades (Living Area and Bedroom)
- Padded Vinyl Ceiling Material
- Mini Blinds (Kitchen)
- Fluorescent Interior Lighting
- Halogen Decorative Lighting
- J-Stone™ Solid Surface Countertops and Sink Covers (Kitchen and Bathroom)
- Recessed Kitchen Sink and Stove Top
- Hardwood Slide-Out Fascia Boards

Optional

- Concord Cherry Cabinetry with Raised Panel Doors, Brass Hardware and Hidden Hinges
- Roman Shades
- Corian™ Countertop with Molded Sink, Delta Faucet and Sink Covers (Kitchen Only)
- Accessories Package (Dust Buster®, Rechargeable Flashlight, Phone, Hairdryer)

FLOORING

Standard

- Vinyl Tile Flooring in Kitchen and Bathroom
- Color Coordinated Carpet with 1/2" Pad in Living Area and Bedroom

Optional

- Ceramic Tile Flooring in Kitchen and Bathroom

APPLIANCES

Standard

- General Electric® Convection Microwave with Ultra Quiet Fan
- Three Burner Range with 21-inch Oven
- Side-by-Side 12-cu.-ft. Refrigerator with New Wraparound Black Panel Door

Optional

- Spacesaver Coffeemaker
- Three Burner Cooktop with Storage Below
- Two Burner Smooth-Top Electric Range without Oven
- Central Vacuum System
- Attic Fan (Kitchen)

INTERIOR/GENERAL

Standard

- Trash Can in Kitchen Pantry
- Phone Jack in Living Area and Bedroom
- 12V Outlet Located with Phone Jack in Living Area
- Cupholders in Cab Area
- PowerDrive™ Electric Slide Room System
- Command Center™ with Centrally Located Controls and Gauges

ENTERTAINMENT

Standard

- Satellite Prep
- 27-inch Color TV in the Living Area
- 20-inch Color TV in Bedroom Area

Optional

- Surround Sound Entertainment Theater System with 5-CD/DVD Changer
- VCR
- Satellite System with Power Lift
- Exterior Entertainment Center with Pull-Out Table
- Exclusive Slide-Out Exterior BBQ Grill

FURNITURE

Standard

- Fabric Recliner
- Free-Standing Hardwood Dinette Table and Two Chairs
- Two Folding Chairs
- Fabric Easy Bed™ Sofa

Optional

- Fabric Love Seat (Replaces Recliner)
- Ultraleather™ Love Seat (Replaces Recliner)
- Ultraleather™ Recliner
- Fabric Hide-a-Bed Sofa
- Ultraleather™ Hide-a-Bed Sofa
- Booth Dinette

BATH

Standard

- Lighted Bath Skylight
- Sealand™ Porcelain Toilet with Sprayer
- Medicine Cabinet
- Power Ceiling Vent
- Molded Fiberglass Full Height Shower Surround with Glass Door
- Mini Blinds
- Coordinating Wallpaper Border

BEDROOM

Standard

- Queen Bed (60" x 80")
- Dresser
- Power Drive™ Electric Slide Room System
- Under Bed Storage
- 12V Outlet

* Ask dealer for AVATAR Exterior Color Choices brochure or visit www.jayco.com
Shown at right: AVATAR full body paint option in Champagne



Specifications

BEDROOM (Cont.)

Standard

Nightstands with J-Stone™ Countertops
Ceiling Vent

Optional

Premium Stereo with CD Player and Alarm Clock

HEAT, POWER AND WATER

Standard

Washer/Dryer Prep
50 amp Service with Flexible Power Cord
10 Gallon Gas/Electric Auto Ignition Water Heater
Below Floor Central Air Conditioning
One 35M BTU Furnace and One 20M BTU Furnace
Generator – Onan® Marquis Gold LP – 6.5 KW
with Slide Tray
Water Pump with Threeway Switches Located in
Bathroom, Kitchen and Exterior Utility Center
Converter
Water Purification System
Water Systems Winterization Kit

Optional

Electrically-Powered 50 amp Cord Reel
Washer/Dryer Combo
Generator – Onan® Quiet Diesel – 7.5 KW with
Slide Tray
2000 Watt Inverter Including Two 6 Volt
Deep Cycle Auxilliary Batteries
Heat Pump
Solar Panel

SAFETY

Standard

Fire Extinguisher
Deadbolt Lock on Entrance Door
120V GFI Protected Circuit
(Kitchen, Bathroom, Exterior)
LP Gas Detector
Smoke Detector
Carbon Monoxide Detector
Pilot and Co-Pilot Three-Point Seat Belts
(Lap and Shoulder)
Third Brake Safety Light
Egress Windows

FREIGHTLINER® XC CHASSIS SPECIFICATIONS

Standard

330 hp Caterpillar® 7.2 Liter Fuel Injection Diesel Engine (Rear Radiator)
Allison® 3000MH 6-Speed Automatic Transmission
Torque: 860 Lbs.-Ft. @ 1440 RPM
Alternator: 160 amp
Rear Axle Ratio: 4.63:1
Power Steering Box: TRW TAS-65
Radial Tires
Tire Size: 275/70R 22.5
Tire Load Range: G
Hitch Receiver: 10,000 Lb. (Gross Weight)

Optional

350 hp Caterpillar 7.2 Liter Fuel Injection Diesel Engine (Side Radiator)

SPARTAN® MOUNTAIN MASTER CHASSIS SPECIFICATIONS

Standard

330 hp Cummins® ISC 8.3 Liter Fuel Injection Diesel Engine (Rear Radiator)
Allison 3000MH 6-Speed Automatic Transmission
Torque: 950 Lbs.-Ft. @ 1300 RPM
Alternator: 160 amp
Rear Axle Ratio: 4.88:1
Power Steering Box: TRW TAS-85
Radial Tires
Tire Size: 275/80R 22.5LRH
Tire Load Range: G
Hitch Receiver: 10,000 Lb. (Gross Weight)

Optional

350 hp Cummins ISC 8.3 Liter Fuel Injection Diesel Engine (Side Radiator)

AUTOMOTIVE AND CHASSIS

Standard

Independent Front Suspension	PAC Break
Gas Shocks	Engine Block Heater
Stainless Steel Wheel Liners	Air Cleaner Restriction Indicator
Full Air Brakes with Automatic Slack Adjusters	Undercoating

Optional

Aluminum Wheels

WEIGHTS

Front Gross Axle Weight Rating (Lbs.)	12,000	12,000
Rear Gross Axle Weight Rating (Lbs.)	19,000	20,000
Gross Vehicle Weight Rating (GVWR) (Lbs.)	31,000	32,000
Gross Combined Weight Rating (GCWR) (Lbs.)	41,000	42,000

Freightliner 330 HP

Spartan 330 HP

TANK CAPACITIES

Gray/Black Tank Capacity	63/53 gal.	63/53 gal.
Fresh Tank Capacity with Water Heater	100 gal.	100 gal.
LP Tank Capacity	132 lbs.	132 lbs.
Fuel Capacity	100 gal.	100 gal.



Fabrics and Woods

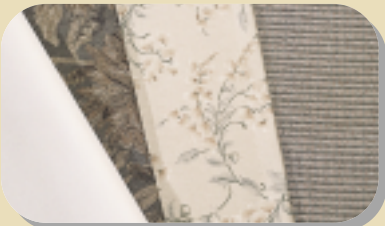

Winter Moss



Mocha Cream



North Ridge Maple

Concord Cherry



Driftwood Silk



Silver Haze

2003 Floorplans

AVATAR 3800 K

Wheelbase	242"
Exterior Length	39'2"
Exterior Height with A/C	11'10"
Interior Height	80"
Interior Width	96"
Exterior Width	102"

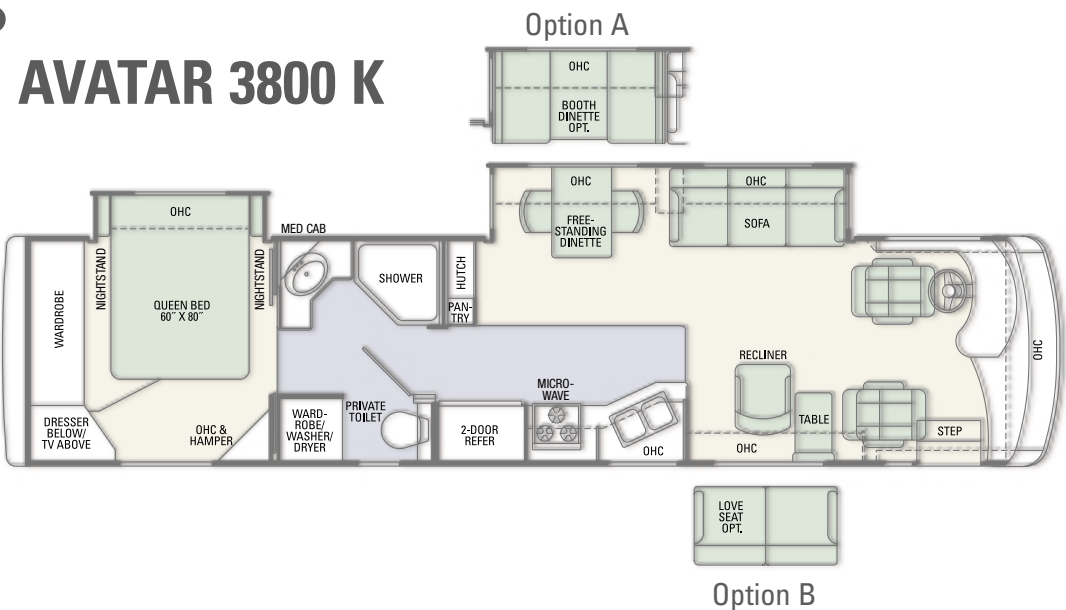

AVATAR 3860 C

Wheelbase	242"
Exterior Length	39'2"
Exterior Height with A/C	11'10"
Interior Height	80"
Interior Width	96"
Exterior Width	102"

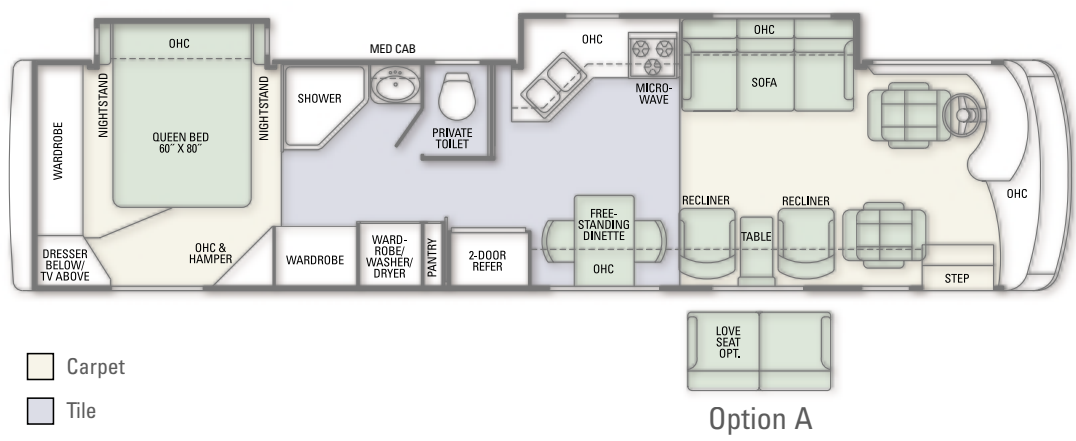

- Carpet
- Tile

Shown on cover: AVATAR full body paint option in Platinum Quartz

Please Note: All information in this brochure is the latest available at the time of publication approval. Jayco reserves the right to make changes and to discontinue models without notice or obligation. It is important that you review weights and ratings before you purchase a new motorhome. Gross Vehicle Weight Rating (GVWR): GVWR means the maximum permissible weight of the motorhome, including the unloaded vehicle weight plus all cargo, passengers, personal items, fluids, options and dealer-installed accessories. Gross Combined Weight Rating (GCWR): equal to the GVWR of the unit plus the weight of a towed vehicle. It is the maximum allowable loaded weight with a vehicle in tow. Jayco affixes a weight label to each new RV which lists weight information for that vehicle. Pictures in this brochure may show optional equipment. RVs built for sale in Canada may differ to conform to Canadian codes.



As a Jayco owner, you can be part of the Jayco Jafari International Travel Club. Ask your dealer about the Jafari "flight" in your area, write Jayco direct or visit Jayco.com.



Jayco, Inc., P.O. Box 460, Middlebury, IN 46540
www.jayco.com