

# ASPIRE

Your dream unveiled.



ENTEGRA  
COACH®



2012 ASPIRE

*Without compromise.*

# The aspiration of all motor coaches, the 2012 Aspire redefines luxury—and your expectations.

**WE IMAGINED EVERY LUXURY.** We dreamed of limitless power. We pictured paradise—*your* paradise. Then, we built the 2012 Aspire.

Nothing less than visionary, the Aspire caters to your every desire. From a 450 HP Cummins engine to an unyielding Spartan chassis, the road is yours to revel in.

Inside, the Aspire is nothing less than a dream. Custom-laid porcelain tiles, Ultraleather furniture and rich, solid hardwoods will exceed your imagination—because our aspiration is to transcend yours.



*Derald L. Bontrager*    *Wilbur L. Bontrager*

DERALD & WILBUR BONTRAGER  
Entegra Coach Founders

THE  
*Bontrager*  
FAMILY PROMISE

After 40 years of building Jayco, the world's largest privately-owned RV manufacturer, our family is proud to stand behind every Entegra Coach we build with the Bontrager Family Promise. It's a promise to provide unflinching customer service—before, during and after the sale. To learn more, visit us online or see your local Entegra Coach dealership.



## ENVIABLE LUXURY

Absolutely uncompromising, the 2012 Aspire's living area is scrupulously designed with luxury in mind. From custom-laid porcelain floors to Ultraleather furniture, Aspire indulges in the finest details.

And with a 40" LCD HDTV, home theatre system with all-in-one remote, electric fireplace and central vacuum system, Aspire flaunts enviable conveniences that will exceed your every desire.

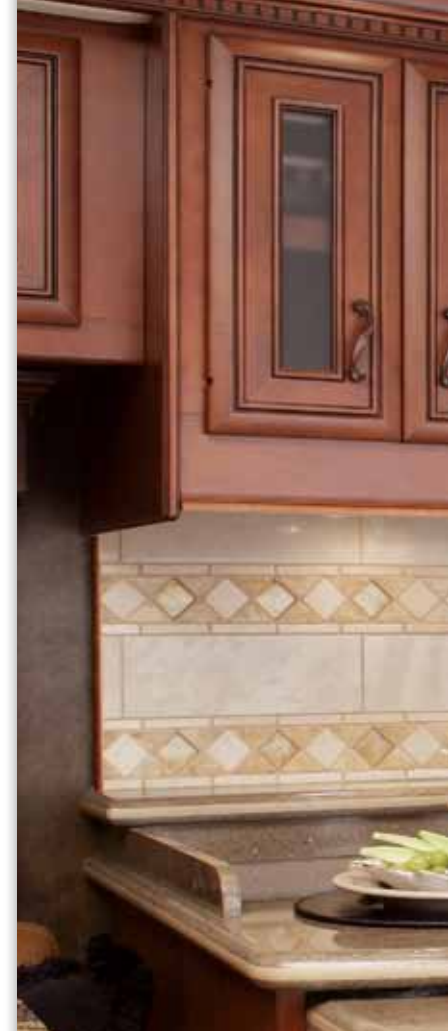

Multiplex lighting system

Aqua-Hot hydronic heating system

32" LCD HDTV

Day/night roller shades

## REFRESHING DETAILS

Dreams can come true—at least in your motor coach. Thanks to rich bedding, a King Select Comfort air mattress (select models), plush designer carpeting and a home theatre system with 5.1 surround sound and all-in-one remote, Aspire redefines relaxation. Meanwhile, Aspire's bathroom features gracious details. From stylish satin nickel hardware, DuPont Corian countertops, a porcelain stool and a one-piece walk-in fiberglass shower, prepare to be pampered.

## DESIGN AND FUNCTION

With a host of remarkable conveniences on the inside, Aspire redefines luxury living with its convenient, everything-at-your-fingertips Multiplex lighting system, Aqua-Hot 375-LP on-demand hot water, 32" bedroom LCD HDTV (26" in select models), home theatre system and day/night roller shades.



## A DINING DREAM

\*Washington Glazed Cherry pictured.

Fulfill your every culinary desire with Aspire, starting with an Amana convection microwave oven, recessed 3-burner range and four-door, 23 cu. ft. residential refrigerator with ice maker. Combine all that with

Amish handcrafted, solid-hardwood cabinetry in Washington Glazed Cherry<sup>®</sup> or Tuscan Glazed Maple and Aspire gives new meaning to fine dining. In fact, you'll discover it's the finest.



Deep sliding drawers



Silverware drawer



Sliding wire rack



Under-sink sliding trash receptacle

## COMFORT AND SAFETY

Aspire's well-appointed cab is a driver's delight. Ingeniously comfortable, it features adjustable foot pedals, powered front sun visors and distressed Ultraleather chairs with six-way power for a heavenly journey. And thanks to a Spartan Message Center, GPS navigation, Bluetooth, touch-screen entertainment and Ultra-Vision wrap-around windshield, you'll do more than just command the road—you'll own it—and every unconquered pass.

ENTEGRACOACH.COM



**INTEGRATED SEAT BELTS**  
Great engineering starts with great priorities. At Entegra Coach, your safety tops our list. That's why we build an integrated 3-point lap and shoulder safety belt into each cab seat—because your safety should never be compromised.



**SMARTWHEEL**  
Aspire's VIP SmartWheel features integrated multiplexed controls. With push-button shift and cruise control, tilt and telescoping steering and everything else you need at your fingertips, the SmartWheel lets you master the road—in a soft-touch, leather-wrapped steering wheel.



**TOUCH-SCREEN**  
In tune with your every need, Aspire features touch-screen entertainment, complete with independent speakers, a rear-view monitor and one-way audio, for the ultimate driving experience.

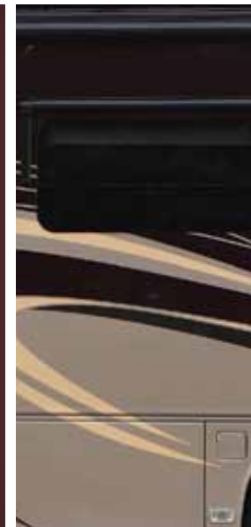



**ENTERTAINMENT**  
Entertain in ultimate style with an optional exterior entertainment system, complete with 32" LCD HDTV, CD/DVD player and speakers.



**SEAMLESS EXTERIOR**  
Aspire's flush-mounted slideouts and frameless windows are only a small reflection of the coach's well-assembled, seamless design, and with the Polar Pack insulation package, the getaway season will be seamless, too.



**SLIDEOUT STORAGE**  
The simplest innovations can lead to the biggest conveniences. Take for instance our easily accessible slideout storage tray with side-hinged baggage doors. Who knew frills could be so simple? We did, of course.



## BUILT TO LAST

At Entegra Coach, we strive to uphold our reputation for integrity. Our construction is no exception. Ingeniously designed, carefully executed, Aspire is built to last, starting with Aluma-Tru Superstructure construction on 16" centers, a fiberglass roof complete with front and rear molded caps and a Polar Pack insulation package, we refuse to compromise on any detail.

1. Rear-molded fiberglass cap with high-mounted integrated air intake
2. Flush-mounted slideout rooms
3. Triple 15,000-BTU low-profile roof A/Cs with heat pumps and drain tubes (2 A/Cs on 40DRQ & 40SKT)
4. Deluxe full-body paint package
5. Porcelain tile with inlays throughout
6. Slideout storage tray
7. Extra large basement storage

8. Smooth gel-coat fiberglass exterior
9. Lauan, 1/2" foam and fiberglass insulation sidewalls
10. Reflective Flexfoil insulation on all 6 sides
11. Frameless tinted dual-pane safety-glass windows
12. Fiberglass roof
13. 3/8" plywood roof decking
14. 3/4" plywood floor decking
15. Wood truss floor risers

16. Steel tubular floor joists
17. X-Bridge frames engineered into chassis
18. Floor and underbelly fiberglass and Flexfoil insulation
19. Side-hinged baggage doors
20. Aluma-Tru Superstructure construction on 16" centers
21. Roof fiberglass and Flexfoil insulation
22. Vinyl padded ceiling
23. Welded crowned aluminum truss rafters 16" on centers
24. Front-molded fiberglass cap
25. Entry door with Sur-Seal air lock
26. Ultra-Vision wrap-around one-piece windshield
27. Daytime running lights
28. Outside generator slideout tray



**SPARTAN CHASSIS, INC.**

[spartanchassis.com](http://spartanchassis.com)

# The premier foundation.

**STRONG. RELIABLE. PROVEN.** At Entegra Coach, we believe foundation is everything, which is why Aspire is built on a Spartan Mountain Master chassis. For over 35 years, Spartan has committed itself to the highest standards in chassis engineering and manufacturing. The result—a fully integrated Class A motor coach that drives and performs beyond your expectations.

*A side-mounted, hydraulically-driven cooling package enhances Aspire's performance*

*Each Spartan chassis is dynamometer tested and laser aligned to create Aspire's superior foundation*

*An Allison 3000 MH electronic 6-speed automatic transmission utilizes the full power of the engine while providing better fuel economy*

*A powder-coated steel frame rail construction withstands corrosion*

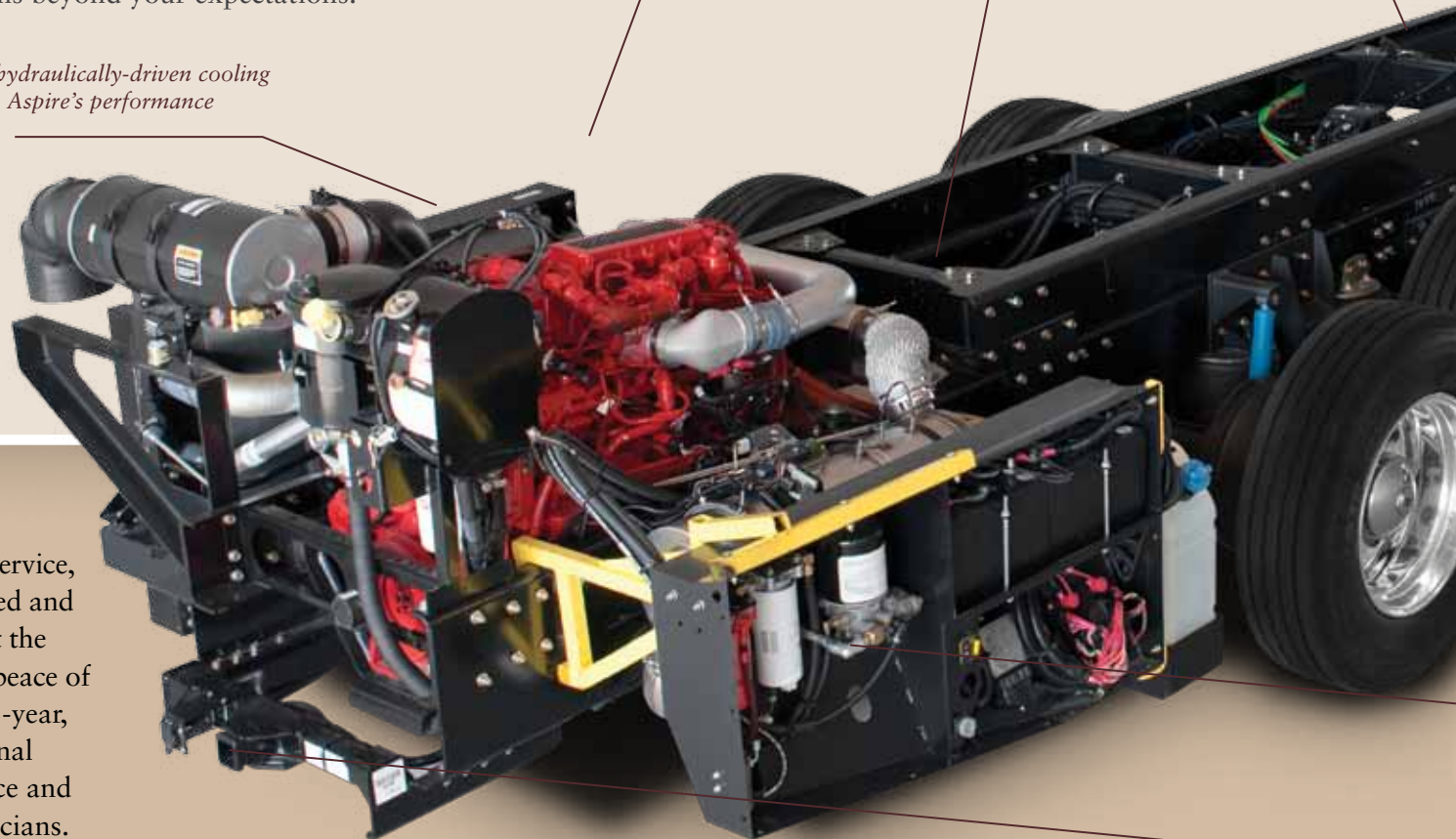

## SUPERIOR SERVICE

Sharing in our passion for customer service, Spartan Chassis offers 460-plus trained and authorized service centers throughout the U.S. and Canada. And because your peace of mind is a priority, Spartan boasts a 3-year, 50,000-mile chassis warranty, National Motor Club 24/7 Roadside Assistance and ASE Certified Factory Service Technicians.



*Aspire's front axle air disc brakes boast superior stopping power*



*The front I-beam suspension is computer analyzed and custom tuned to provide optimal comfort and control*

*100-gallon fuel tanks are accessible from either side of the coach*

*A single service panel offers easy access to filters and components*

*Aspire's integrated hitch provides 15,000 lbs. of towing capacity*



#### REINFORCED DESIGN

Aspire is built to protect you on the road. Engineered to deliver strength where it's needed most, our reinforced front cap and windshield frame are bolted to each sidewall for a structure designed with your safety in mind.



#### X-BRIDGE FRAME

Entegra Coach's exclusive X-Bridge frame helps prevent flexing throughout, averting cracks in tile and grout and reducing windshield movement and noise. Unyielding, the X-Bridge maintains Aspire's rigidity for better suspension and a smoother ride.

## AMERICA'S BEST RIDE

Boasting a Cummins ISL 450 turbocharged horsepower engine with Allison 3000 MH six-speed transmission and electronic shifter, Aspire has power to spare, while its muffled Jake brake system provides quieter, more efficient braking.



## EXTERIOR GRAPHIC CHOICES

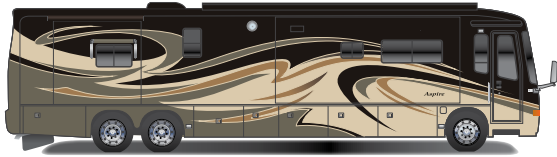

RADIANT BRONZE

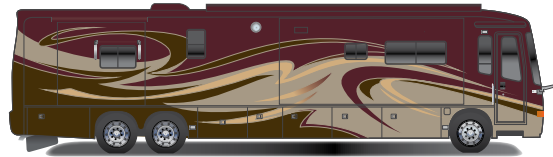

GOLDEN GARNET

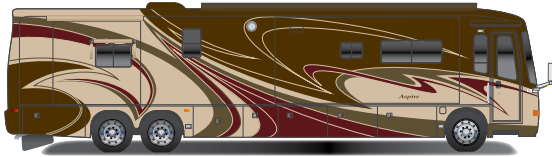

AUTUMN BERRY

## FABRIC CHOICES



BENTLEY BLACK



CRÈME BRULÉE



CABERNET

## WOOD

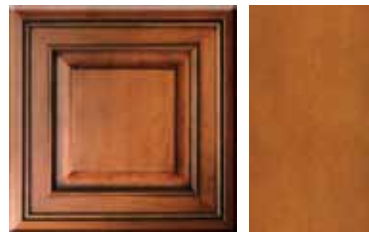

WASHINGTON GLAZED CHERRY



TUSCAN GLAZED MAPLE

## FLOORPLANS

### ASPIRE | 40DRQ | OPTIONS A, B, C, E

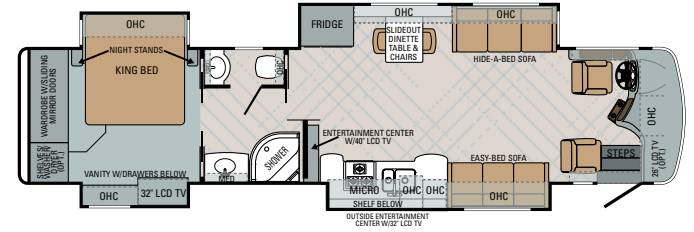

### ASPIRE | 40SKT | OPTIONS B, C, E

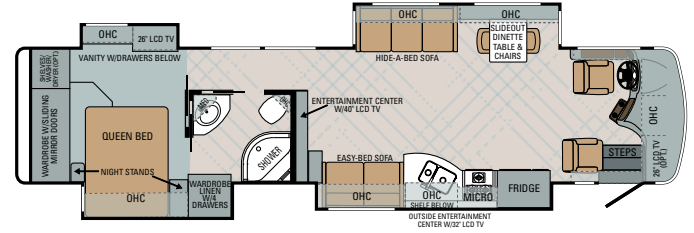

### ASPIRE | 42DLQ | OPTIONS A, B, C, D, E

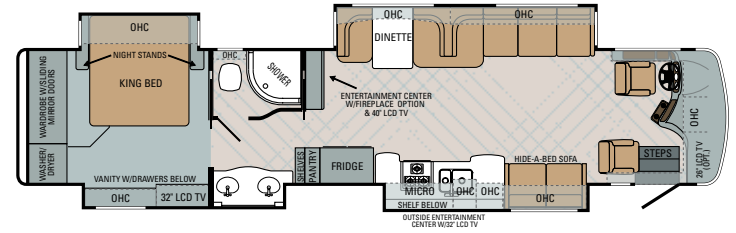

### ASPIRE | 42RBQ | OPTIONS A, B, C, D, E

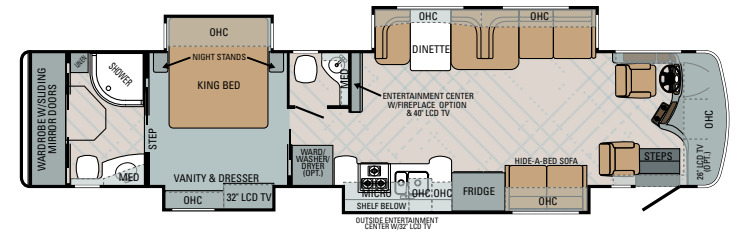

## OPTIONS

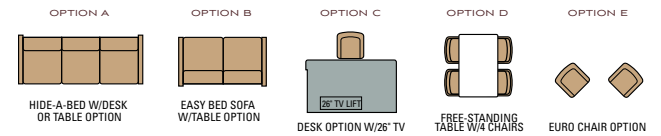

WARD = wardrobe | LAV = bathroom sink | MICRO = microwave  
 OHC = overhead cabinets | FRIDGE = refrigerator | MED = medicine cabinet

## SPECIFICATIONS

## STANDARDS AND OPTIONS

FLOORPLAN	40DRQ	40SKT	42DLQ	42RBQ
GVWR (LBS.)	32,400	32,400	45,860	45,860
GCWR (LBS.)	47,600	47,600	60,860	60,860
FRONT GAWR (LBS.)	12,600	12,600	13,860	13,860
REAR GAWR (LBS.)	20,000	20,000	20,000	20,000
TAG AXLE GAWR (LBS.)	—	—	12,000	12,000
WHEEL BASE	276"	276"	296"	296"
OVERALL LENGTH	40' 9"	40' 9"	43' 1"	43' 1"
OVERALL HEIGHT WITH AIR & SATELLITE	12' 8"	12' 8"	12' 10"	12' 10"
EXTERIOR WIDTH	101"	101"	101"	101"
INTERIOR HEADROOM	84"	84"	84"	84"
FRESH WATER CAPACITY (GALS.)	81	81	81	81
GREY WASTE WATER CAPACITY (GALS.)	60	60	60	60
BLACK WASTE WATER CAPACITY (GALS.)	60	60	60	60

### STANDARD BATHROOM EQUIPMENT

2-panel residential-style solid hardwood passage doors  
 One-piece radius fiberglass shower with integrated seat  
 Residential medicine cabinet with mirror  
 Soap dispenser  
 Thetford Aria porcelain stool with push-button flush

### STANDARD BEDROOM EQUIPMENT

Home theatre system, Dolby Digital 5.1 Surround Sound  
 King Select Comfort air mattress (Queen on 40SKT)  
 Samsung 32" LCD HDTV (26" LCD HDTV in 40SKT)

### STANDARD KITCHEN EQUIPMENT

Amana 1.6 cu. ft. convection microwave oven with carousel  
 Amana recessed, sealed 3-burner range  
 Corian solid-surface countertops with integrated sink  
 Cutting board  
 Deep sliding drawers  
 High-rise, single-lever faucet with pull-out sprayer  
 Porcelain tile backsplash with inlays  
 Silverware drawer  
 Slideout dinette table with (2) comfort chairs and (2) folding chairs (40DRQ, 40SKT)  
 Trash can and sink cover storage compartment under sink  
 Whirlpool 23 cu. ft. residential refrigerator with ice maker and water dispenser

### DRIVER COMPARTMENT AMENITIES

3-point lap and shoulder safety belts integrated into driver and passenger seats  
 12V auxiliary in-dash receptacles (2)  
 A/C/heater vents by foot pedals  
 Adjustable foot pedal  
 Battery boost switch  
 Chassis battery disconnect  
 Cruise control (SmartWheel controlled)  
 Fog lights  
 High-output dash heater and A/C  
 Intermittent windshield wipers, single motor (SmartWheel controlled)  
 Leather-wrapped steering wheel  
 Powered stepwell cover with pinch resistance technology  
 Powered Ultraleather driver and passenger seat  
 Push-button shift control  
 Side cameras with turn signals  
 Side sun visors and privacy shade  
 Sirius radio and tuner  
 SmartWheel steering with integrated controls for systems  
 Spartan Message Center with LCD display featuring: odometer, tachometer, instantaneous fuel economy, fuel remaining, outside air temp., coolant temp., engine oil temp. and pressure, transmission temp., turbo boost pressure, air pressure, diagnostic functions, fault codes, service reminders, percentage of engine load, trip meter, speed and voltage  
 Storage compartment(s) beside passenger seat  
 Tilt and telescoping steering

Touch-screen AM/FM/CD/DVD with GPS navigation, Bluetooth and 4 speakers  
 Ultra-Vision one-piece wrap-around tinted windshield

### STANDARD CHASSIS EQUIPMENT

2 chassis batteries  
 4.88 rear axle ratio  
 55-degree turning radius  
 100-gal. fuel tank (dual fill)  
 170-amp alternator  
 275/80R 22.5" radial tires  
 1,000-watt in-block engine heater  
 13,860-lb. front axle I-beam wide track  
 15,000-lb. hitch with 7-pin plug  
 Allison 3000 MH 6-speed shift pad electronic transmission  
 All-wheel ABS brakes  
 Automatic heated moisture ejectors  
 Bendix Air Disc front brakes  
 Bilstein shocks  
 Cummins ISL turbocharged 450 HP engine 1,250-lb. ft. torque at 1,400 RPM  
 Daytime running lights  
 Neway air suspension  
 Polished aluminum wheels  
 Raised rail for maximum storage  
 Rear axle 20,000-lb. rated  
 Side-mounted radiator with fan clutch  
 Spartan Mountain Master tag axle chassis  
 Remote air fill with air hose  
 Tag axle 12,000-lb. rated (42DLQ, 42RBQ)  
 Tag axle auto-weight release  
 Two-stage Jake brakes

### STANDARD CONSTRUCTION FEATURES

3/4" plywood main floor decking  
 1-1/2" welded tubular-aluminum sidewall construction  
 2" x 4" floor trusses  
 4-1/2" arched aluminum truss roof  
 Aluma-Tru Superstructure construction on 16" centers  
 Enclosed, insulated and heated floor and underbelly (R-33)  
 Frameless flush-mounted slideout rooms  
 Fully decked roof with 3/8" plywood  
 One-piece fiberglass roof  
 Polar Pack insulation with reflective Flexfoil floor (R-33), roof (R-24), sidewalls (R-16)  
 Reli-torq slideout system  
 Sidewalls bolted to frame  
 Steel reinforced front cap and windshield frame  
 X-Bridge frames engineered into chassis

### STANDARD EXTERIOR EQUIPMENT

Carefree armored power entrance door awning  
 Carefree armored slideout awnings  
 CB antenna  
 Docking lights  
 Entry door with Sur-Seal air lock  
 Frameless dual-pane tinted safety-glass windows  
 Hadley air horns

Hydraulic automatic leveling jacks (dual positive)  
 Keyless entry key fob and keypad system  
 Rear-molded fiberglass cap with integrated rear intake  
 Roof ladder  
 Samsung 32" LCD HDTV with CD/DVD player and speakers  
 Slideout cargo tray  
 Sliding battery tray (2 positions)  
 Uni-Dock exterior utility center, heated and enclosed with second system monitor panel  
 Window awning(s)

### STANDARD INTERIOR EQUIPMENT

2-panel residential-style solid hardwood passage doors throughout  
 Aire-Secure travel locks for all passage doors  
 All-in-one home theatre remote  
 Central vacuum system with vac pan  
 Crank-up HDTV antenna with signal booster  
 Day/night roller shades throughout  
 Glazed cherry or maple solid hardwood cabinetry and miter-cornered raised-panel doors throughout  
 Hardwood cabinets and slideout fascia  
 Home theatre system, Dolby Digital 5.1 Surround Sound (living room and bedroom)  
 High-gloss porcelain tile floor inlays  
 Multiplex lighting  
 Samsung 40" LCD HDTV in living area  
 Slideouts controlled with key-fob remote  
 Ultraleather furniture package

### HEAT, POWER AND WATER EQUIPMENT

3rd 15,000-BTU A/C with heat pump and 10,000-watt generator (42DLQ and 42RBQ)  
 5-watt solar panel (for chassis batteries)  
 50-gal. propane gas tank, chassis-mounted  
 50-amp quick-connect power cord with electric reel  
 2,800-watt pure sine wave inverter with 4-6V batteries  
 Aqua-Hot 375-LP hydronic water and heating system with in-floor heat throughout  
 Dual 15,000-BTU low-profile central A/Cs with heat pump, digital thermostat, Chillgrille and drain tubes  
 Electric powered cord reel  
 Onan 8,000-watt diesel generator with auto-changeover on sliding tray (40DRQ and 40SKT)  
 Onan auto generator and temperature start system  
 Power auto rewind water hose power  
 Total coach water filter

### OPTIONS

Samsung 26" LCD HDTV, front overhead  
 Desk in lieu of lounge (n/a with dinette sofa ensemble)  
 Fireplace (42DLQ, 42RBQ)  
 Free-standing table with 4 chairs and sofa (42DLQ, 42RBQ)  
 Leather chairs (2) (n/a with desk option/dinette sofa ensemble)  
 Norcold 12 cu. ft. 4-door refrigerator with ice maker  
 Stackable washer and dryer  
 Winegard in-motion dome satellite dish



ENTEGRA  
COACH®

*Without compromise.*

A reputation for integrity isn't built overnight. It happens only after years of doing what you say you will do—and by practicing the Golden Rule.

Over the last 40 years, the Bontrager family has worked hard to establish a reputation of integrity in the RV business. Through ups and downs, successes and failures, these four decades have taught us the importance of doing our best to meet our customers' expectations. And that is why we are excited to introduce the finest line of RVs we have ever built—the motor coaches from Entegra Coach.

We believe Entegra Coach captures everything we stand for, from its structural quality and old-world craftsmanship, to unmatched customer service. We hope you'll take some time with your local dealer to understand why our family stands so strongly behind Entegra Coach.

## 2-YEAR WARRANTY (5-YEAR STRUCTURAL)

Our family is proud to stand behind every Entegra Coach we build. That's why we back our motor coaches with a manufacturer's limited warranty against defects in materials and workmanship, warranted to the original purchaser for two years (five years structural) from the original date of purchase or 24,000 miles of use, whichever comes first. Our commitment is to provide you with the highest level of products and services possible. We invite you to compare us with other manufacturers—we think you'll find that your satisfaction is our lifelong passion. For a copy of the limited warranty with full terms and conditions, ask your local Entegra Coach dealer.

[WWW.ENTEGRACOACH.COM](http://WWW.ENTEGRACOACH.COM)



## 3-YEAR PLATINUM-LEVEL ROADSIDE ASSISTANCE

We promise peace of mind in countless ways with the Entegra Coach Customer First Roadside Assistance program, yours at no cost during your first three years of ownership. Offered through Motor Coach Club, the largest RV emergency road service in the country, this program gives you immediate access to dependable roadside assistance and support services with a simple phone call.

- 24/7 technical support and assistance technicians
- Service appointment assistance
- Mobile mechanic
- Emergency road towing and winching
- Delivery of emergency fluids
- Flat tire service
- Jump start/battery boost
- Lockout service
- Complete concierge service (including many types of errands and personal services)

**GROSS VEHICLE WEIGHT RATING (GVWR):** The maximum permissible weight of the motor coach, including the Unloaded Vehicle Weight (UVW) plus passengers, personal items, all cargo, fluids, options and dealer-installed accessories. The GVWR is equal to or greater than the sum of the UVW and the Cargo Carrying Capacity.

**GROSS AXLE WEIGHT RATING (GAWR):** The maximum allowable weight each axle assembly is designed to carry, as measured at the tires, therefore including the weight of the axle assembly itself.

**GROSS COMBINED WEIGHT RATING (GCWR):** The maximum allowable combined weight of the motor coach used as a tow vehicle and the attached towed vehicle.

It is important for your safety and enjoyment that you are aware of the weights and tow ratings of the RV you select. Consult a competent advisor for questions or advice. Whether you are new to RVing or a veteran, get a feel for the performance of your RV before heading out on the roadways. When you tow a vehicle with your RV, you must drive differently than when you drive a single vehicle. Practice hooking up, driving, backing up and braking in a safe environment or seek out professional instruction. Entegra Coach affixes a weight label to each RV which lists weight information for that vehicle. Refer to that label to verify the vehicle will meet your requirements. See specifications chart inside.

See dealer for further information and prices. All information in this brochure is the latest available at the time of publication approval. Entegra Coach reserves the right to make changes and to discontinue models without notice or obligation. Photos in this brochure may show optional equipment and props for photography purposes. RVs built for sale in Canada may differ to conform to Canadian codes. ©2011 Entegra Coach, Inc. 12-ASPR-PL 0711-20K Printed in U.S.A.

Entegra Coach, Inc., P.O. Box 460, Middlebury, IN 46540 | [www.entegracoach.com](http://www.entegracoach.com)