

2013 American Coach American Tradition 42G

<http://www.DreamFindersRV.com/RV/7708237/details.htm>

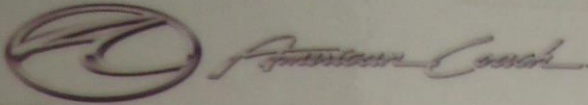

DEALER
 ANCIRA GMC TRUCKS & MOTORHOMES INC
 ADDRESS
 DBA ANCIRA TRAVEL VILLA
 5201 S 135 W
 ALVARADO, TX 76009

AS109

MANUFACTURER'S SUGGESTED RETAIL PRICE

MANUFACTURING PLANT
 FLEETWOOD RV, INC. 44-MANUFACTURING PO BOX 31
 BRAND-MODEL-COLOR
 AMERICAN TRADITION 42G CHAMPAGNE & PEARLS/EBONY GLAZE

INV REF NO.
 12000286
 MODEL YEAR
 2013
 Date of manufacture
 12/12/2012

VEHICLE SERIAL NUMBER
 780GD4412694

| THE FOLLOWING ITEMS ARE STANDARD ON THIS MODEL AT NO EXTRA CHARGE | | MANUFACTURER'S SUGGESTED RETAIL PRICE OF THIS MODEL | 457,113.00 |
|---|-----|--|--------------------------------|
| ONE PIECE FIBERGLASS ROOF | N/C | OPTIONAL EQUIPMENT INSTALLED ON THIS VEHICLE BY MANUFACTURER | |
| APPROX 100 GAL FRESH WTR SYS | N/C | | |
| APPROX 40 GAL WASTE TANK | N/C | OPTION | DESCRIPTION |
| APPROX 60 GAL GREY WATER TANK | N/C | 004 | FREIGHTLINER CHASSIS - 450HP |
| HOLDING TANK SANI-FLUSH SYSTEM | N/C | 051 | REAR LADDER |
| RAIN SENSOR PWR ROOF VENT 3/SP | N/C | 091 | EXTERIOR TV-SIDEWALL MNTD |
| FULL BODY PAINT | N/C | 095 | SAT DISH WINGARD IN-MOTION |
| FRONT MASK/CLEAR | N/C | 107 | DISHWASHER |
| CEILING FAN - BEDROOM | N/C | 304 | SOLAR ELECTRICAL PANEL |
| SIDE HINGE LUGGAGE DOORS | N/C | 546 | WSTMNGMNT PUMP W/PWR WTR HS RL |
| LIBERTY CHASSIS | N/C | 594 | POWER SHADE PACKAGE |
| ROOF MOUNT AWNING PKG | N/C | 676 | CHAMPAGNE & PEARLS |
| TRAILER HITCH- 15000 LB CAP | N/C | 693 | CUSTOM ORDER REQUEST |
| REAR ROCKGUARD W/STN STL TRIM | N/C | 856 | KING BED AIR MATT - SELECT COM |
| AIR HORNS | N/C | 915 | HEATED TILE FLOOR (G) |
| ADJUSTABLE PEDALS | N/C | GES | SOC CHARGES 10/1/12 |
| AUTOMATIC TRACTION CONTROL | N/C | | |
| DRIVER'S SIDE POWER WINDOW | N/C | | |
| REMOTE HTD. REAR VIEW MIRRORS | N/C | | |
| INDEPENDENT FRT SUSPENSION | N/C | | |
| DUAL MONITORS (DASH) | N/C | | |
| SONY HOME THEATER SYSTEM | N/C | | |
| 32" SONY LCD (BDRM) | N/C | | |
| 46" SONY LED TV (LIV RM) | N/C | | |
| PWR TV ANTENNA W/WARNING SYS. | N/C | | |
| RESIDENTIAL STYLE REFRIGERATOR | N/C | | |
| 2 BURNER COOKTOP ELECTRIC | N/C | | |
| MICROWAVE CONVECTION OVEN | N/C | | |
| STACKABLE WASHER/DRYER | N/C | | |
| WHOLE COACH WATER FILTER SYS | N/C | | |
| SHOWER ENCLOSURE W/OBSCURE GLA | N/C | | |
| AQUAHOT HYDRONIC HEATING | N/C | | |
| 3 LOW PROF ROOF A/C W/DRAINS | N/C | | |
| A/C LOW PROFILE W/HEAT PUMP | N/C | | |
| PURE SINE 2800 & 2000 WATT INV | N/C | | |
| ELECTRIC POWER CORD REEL | N/C | | |
| 12 VOLT LED LIGHTS | N/C | | |
| LIGHTED ENTRY ASSIST HANDLE | N/C | | |
| MULTI-PLEX 12V SWITCHING | N/C | | |
| AIR&HYDRAULIC LEVELING SYSTEM | N/C | | |
| SURGE GUARD ELEC SYS PROTECT | N/C | | |
| AGM MAINTENANCE FREE BATTERIES | N/C | | |
| 10 KW DIESEL GEN W/POWER S/O | N/C | | |
| AUTO GENERATOR START | N/C | | |
| DECORATIVE GALLEY/LAVY BKSPLSH | N/C | | |
| DAY/NIGHT PLEATED SHADES | N/C | | |
| DUAL GLAZED RADIUS WINDOWS | N/C | | |
| AIR LATCH AVIONICS ENTRY DOOR | N/C | | |
| KEYLESS ENTRY | N/C | | |
| ONE PIECE WINDSHIELD | N/C | | |
| ALUMINIUM WHEELS | N/C | | |
| INTERLOCKING ALUM CONNECTIONS | N/C | | |
| INTEGRATED 3-POINT SEAT BELTS | N/C | | |
| APPROX 150 GAL FUEL TANK W/DEF | N/C | | |
| 200 AMP ALTERNATOR | N/C | | |
| ULTRA LTHR FURNITURE W/PILLOWS | N/C | | |
| SOLID SURFACE COUNTER TOPS | N/C | | |
| HARDWOOD CABINETRY | N/C | | |
| PORCELAIN TILE FLOORING | N/C | | |
| ULTRA-LTHR DRIP/PASS RECL SEATS | N/C | | |
| 84" INTERIOR HEIGHT | N/C | | |
| COACHNET 24/7 SERVICE 1YR | N/C | | |
| | | OPTIONS SUBTOTAL | 29,294.00 |
| | | VEHICLE TOTAL | 486,406.00 |
| | | DESTINATION CHARGE | 1950.00 |
| | | DEALER PREP. | 1000.00 |
| | | OTHER | |
| | | TOTAL AMOUNT | 489,356.00 |

FLEETWOOD RESERVES THE RIGHT TO CHANGE PRICE AND SPECIFICATIONS WITHOUT NOTICE.

TOTAL AMOUNT DOES NOT INCLUDE STATE AND LOCAL TAXES OR LICENSE FEES. THE PRICE SHOWN ABOVE MAY OR MAY NOT BE REPRESENTATIVE OF THE ACTUAL SELLING PRICE OF SIMILAR RECREATIONAL VEHICLE IN YOUR AREA.

AFFIX TO UNIT

REVOLUTION

TRADITION

DRIVING YOUR PASSION

EAGLE

HERITAGE

GALLERY

FLOOR PLANS

FEATURES

DÉCOR

CHASSIS

DEALER LOCATOR

BUILD YOUR OWN

BROCHURE

2013 AMERICAN TRADITION

A T & T A T & T

With a broad selection of seating, sleeping and storage options and a range of sizes and features, your perfect floor plan awaits. From hand-laid custom tile and handcrafted cabinetry, to full-wall slides and 30"-deep slide boxes, American Coach offers floor plan options for everyone.

AMERICAN TRADITION 42G

MSRP: \$457,113 See dealer for details

VIEW ALL OPTIONS

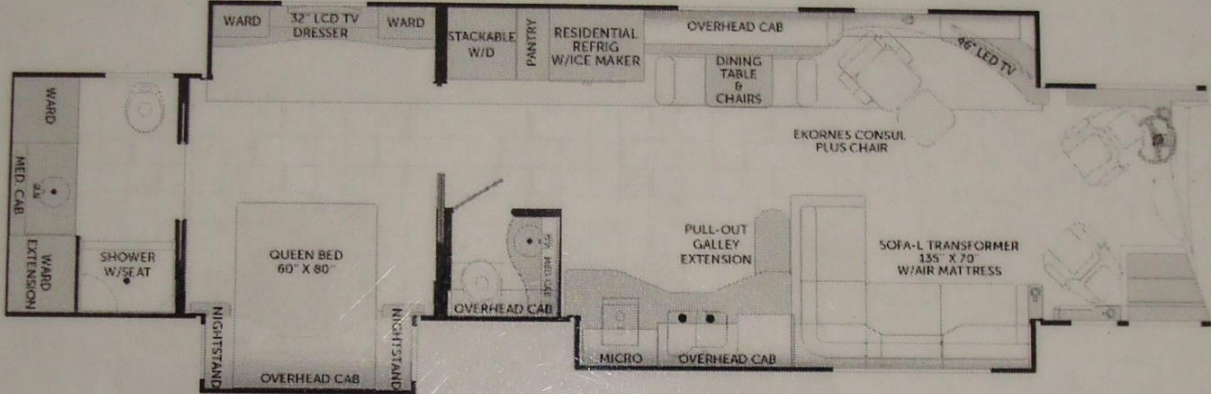

Select to review additional floor plans.

42G

42M

Weights and Measurements

| | Liberty® 450 |
|--|--------------|
| Wheelbase (inches) | 302" |
| GVWR (lbs) ¹ | 46,700 |
| Front GAWR (lbs) ² | 17,000 |
| Tag Axle GAWR (lbs) ² | 10,000 |
| Rear GAWR (lbs) ² | 20,000 |
| GCWR (lbs) ³ | 62,000 |
| Hitch Rating Weight (lbs) ⁴ | 15,000 |
| Tongue Weight (lbs) ⁴ | 1,500 |

Liberty® Chassis Details

Liberty® 450
 Model: Freightliner® XCM Series
 Engine: Cummins® 8.9L ISL w/2-Stage Engine Brake
 Transmission: Allison® 3000 MH, 6-Speed w/Electronic Shifter
 Alternator: 200 Amp Leece-Neville
 Torque: 1,250 lb-ft @ 1,400 RPM
 Horsepower: 450HP
 Fuel Capacity: 150 gal.

Dimensions and Capacities

| | Liberty® 450 |
|---|--------------|
| Overall Length (feet and inches) ⁵ | 42' 11.5" |
| Overall Height (with A/C) (feet and inches) | 12' 11.75" |
| Overall Width (maximum) (inches) ^{6,7} | 102" |
| Interior Height (maximum) (inches) | 84" |
| Interior Width (maximum) (inches) | 96" |
| Fresh Water Holding Tank (gal) | 100 |
| Grey Water Holding Tank (gal) | 60 |
| Black Water Holding Tank (gal) | 40 |

Footnotes and Disclaimers