

 BEAVER 2005 SANTIAM®

ONE COACH AT A TIME.

YOURS.™



 BEAVER 2005 SANTIAM™

The marriage of style and craftsmanship.



Step aboard the Santiam, and you'll be amazed at the many exquisite details that make this coach a home. It all begins with the residential-style woodwork, featuring raised panel hardwood cabinet doors, crown molding and hardwood slide-out fascia trim with a decorative center block. In the dining area you'll enjoy the round hardwood table with two beautifully upholstered chairs

and two handy folding chairs. Other highlights include plush designer carpeting, sleek ceramic tile flooring, decorative hardwood/fabric window treatments and halogen lights mounted under the overhead cabinets. You'll also enjoy customizing your coach with a long list of furniture options, in your choice of rich fabrics or soft, durable Ultraleather™ coverings.





40' PDQ shown in Williamsburg Manor decor with Autumn Cherry cabinetry



40' DST shown in New Leaf decor with Vintage Oak cabinetry

1



2

- 1.** In the front of the coach, you'll find the entertainment center, featuring a 24" flatscreen CRT stereo TV, which is wired through the ceiling speakers for superior sound quality. Some exciting options include a home theater system with DVD/VCR player and a fully automatic digital satellite system.
- 2.** This optional Ultraleather™ J-lounge combines roomy comfort with a convenient storage drawer below.

The choice is yours.



Beaver coaches have always been known for giving you more ways to help you create a coach that's distinctively your own. This year, the Santiam is available in four color schemes with stunning fabric combinations. In addition,

you have your choice of a wide selection of innovative double, triple and quad slide-out floorplans, in lengths ranging from 36' to 40', with numerous furniture options to fit your lifestyle. Now, it's all up to you.

BETTER STAIN PROTECTION



Manufactured in, not added on. For added protection against stains, Dupont Teflon® soil repellent is applied to virtually all upholstery fabric during the finishing process for superior coverage.*

*Brand and application of upholstery fabric protection may vary depending on date recreational vehicle was manufactured.



"Iron Age"

SOFA DINETTE BEDSPREAD CARPET



"Kensington Vine"

SOFA DINETTE BEDSPREAD CARPET



Note: Interior and exterior colors depicted are a reasonable representation though they may not be an exact match of the actual colors due to variances in processing and production. See your dealer for actual fabric and paint chip samples.



"New Leaf"

SOFA DINETTE BEDSPREAD CARPET



"Williamsburg Manor"

SOFA DINETTE BEDSPREAD CARPET



Vintage Oak



Autumn Cherry (option)



Maple (option)

2005 Santiam Floorplans

● Carpet ● Tile

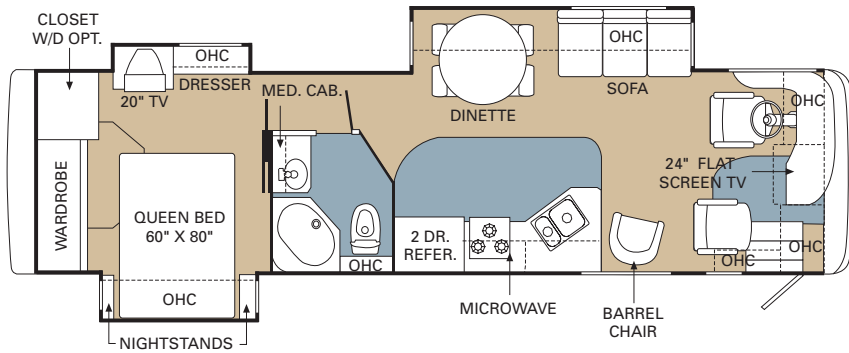

36' SKT Floorplan

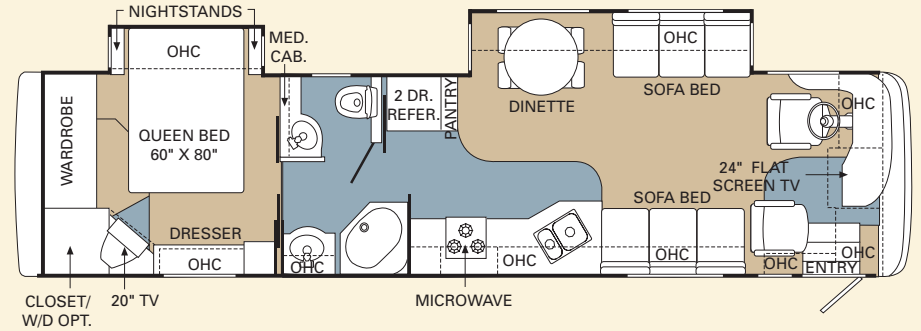

38' PDD Floorplan

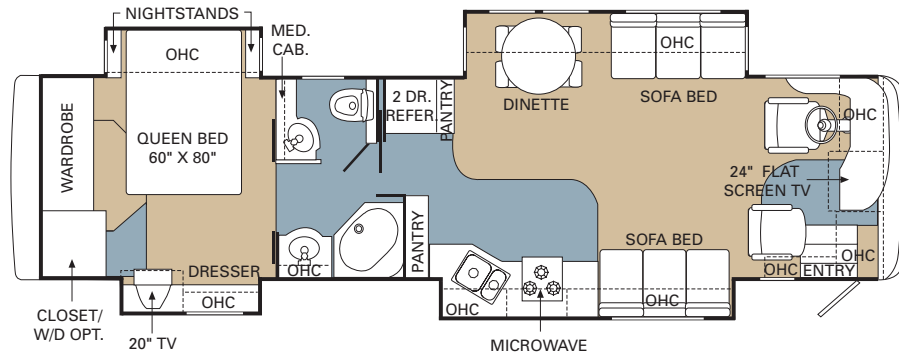

38' PDQ Floorplan

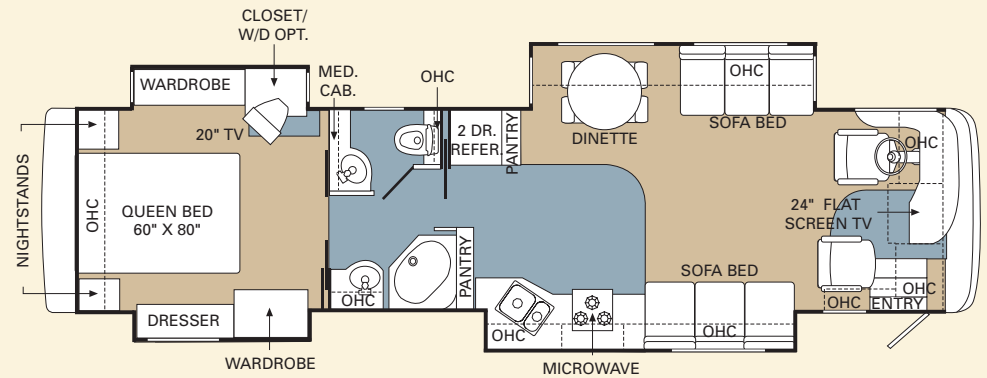

40' PRQ Floorplan

2005 Santiam Floorplans

● Carpet ● Tile

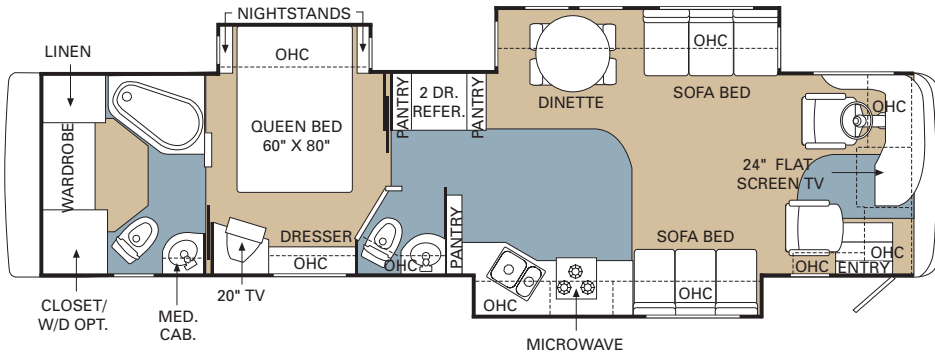

40' DST Floorplan

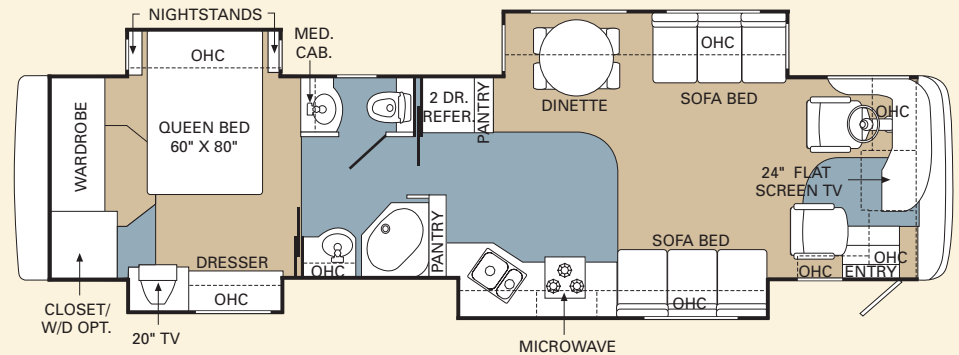

40' PDQ Floorplan

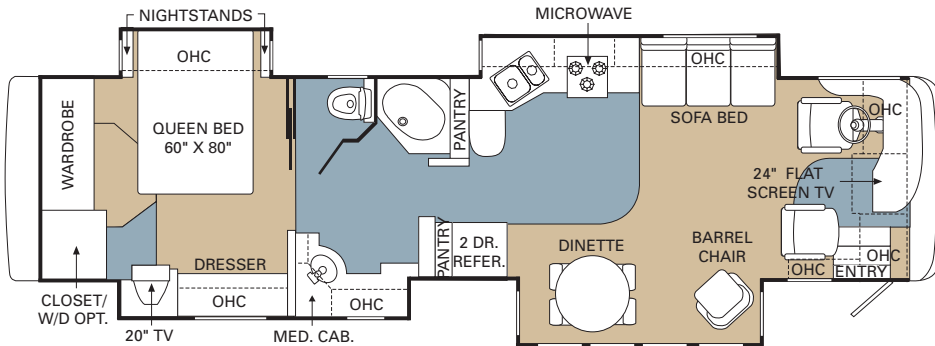

40' PAQ Floorplan

2005 Santiam Floorplan Options

Curbside Ultraleather™ J-Lounge with Drawer:
38' PDQ, 38' PDD, 40' PRQ, 40' DST, 40' PDQ

Curbside Fabric or Ultraleather™ Recliner:
36' SKT, 38' PDD, 40' PAQ

Curbside Ultraleather™ DE Sofa:
38' PDQ, 38' PDD, 40' PRQ, 40' PDQ

Curbside Fabric or Ultraleather™ Magic Bed Sofa:
38' PDQ, 38' PDD, 40' PRQ, 40' PDQ

Curbside Fabric or Ultraleather™ Hide-A-Bed with Air Mattress:
38' PDQ, 38' PDD, 40' PRQ, 40' PDQ

Roadside Fabric or Ultraleather™ Hide-A-Bed with Air Mattress:
36' SKT, 38' PDQ, 38' PDD, 40' PRQ, 40' DST, 40' PAQ, 40' PDQ

Roadside Fabric Magic Bed Sofa:
36' SKT, 38' PDQ, 38' PDD, 40' PRQ, 40' DST, 40' PAQ, 40' PDQ

Roadside Ultraleather™ DE Sofa:
36' SKT, 38' PDQ, 38' PDD, 40' PRQ, 40' DST, 40' PAQ, 40' PDQ

Roadside Wraparound Computer Desk with Euro-Recliner with Ottoman:
38' PDQ, 38' PDD, 40' PRQ, 40' PDQ

Ultraleather™ Extra-Wide Co-Pilot Seat with Power Footrest:
36' SKT, 38' PDQ, 38' PDD, 40' PRQ, 40' DST, 40' PAQ, 40' PDQ

Bedroom Window Awning on Sidewall:
38' PDD, 40' DST, 40' PDQ

Bathtub:
36' SKT, 38' PDQ, 38' PDD, 40' PRQ, 40' PAQ, 40' PDQ

Adjustable Coffee Table:
36' SKT, 38' PDQ, 38' PDD, 40' PRQ, 40' DST, 40' PAQ, 40' PDQ

Booth Dinette:
36' SKT, 38' PDQ, 38' PDD, 40' PRQ, 40' DST, 40' PDQ

Combination Washer/Dryer:
36' SKT, 38' PDQ, 38' PDD, 40' PRQ, 40' DST, 40' PAQ, 40' PDQ

2005 Santiam Specifications

Body Construction

Standard Features

Alumaframe® Superstructure
 Steel Cage Cockpit Construction
 Peaked Aluminum Roof with Fiberglass Insulation
 Smooth Gel Coat Fiberglass Exterior Walls
 Front Molded Fiberglass Cap
 Rear Molded Fiberglass Cap with Integrated Air Intake
 One-Piece Generator Access Door
 Rear Engine Door Struts
 Angled Fiberglass Engine Cover
 Steel Framed Floor on Steel Trusses
 Laminated Structurwood™ Flooring
 Electric Flush Floor Stepwell Cover
 Interior Paneling with 3/4" Insulation
 Foam Insulated Floor Framing with Luau Backer
 Power Heated Remote Exterior Mirrors
 Headlamp with Turn Signal
 Fog Lights
 Flush Mount Metal Fuel Doors
 Side-Hinged Baggage Doors, Storage Compartments Only
 One-Piece Polyethylene Pass-Through Storage Compartment
 Wheel Mud Flaps
 Deluxe Full-Body Paint
 Beaver Dot to Front and Rear Caps
 Interior Entry Step Storage
 Roof Ladder
 Undercoating

Options

Storage Bay Slide-Out Tray
 17.5" Chrome Power Heated Mirror with Turn Signal
 Full-Length Mud Flap

Slide-Out Battery Tray
 3M® Film Front Mask

Cockpit

Standard Features

Automotive Dash with Carpathian Elm IP Panel
 Dash 12V Chassis Battery Gauge
 CD Player/Radio with Six Speakers
 Power Sunvisors
 Pleated Front Privacy Drape with Braided Tie Backs
 Wood Framed Cabinet Doors with Smoked Glass over Front Entertainment Center Systems
 Adjustable Brake and Accelerator Pedals
 110V, 12V and Phone Outlet
 Color Rear Vision System
 Lighted VIP Smartwheel® Multi-Plexed Steering Wheel with Controls for Windshield Wipers, ICC and Cruise Control
 Intermittent Windshield Wipers
 6-Quart Tank for Windshield Fluid with Fluid Sensor to Tank and "Low Wash" Indicator on Dash
 Audible Turn Signals
 Roof-Mounted Air Horn
 Two-Tier Cup Holders Center Console and Passenger Side Console
 CB Prep
 Ultraleather™ with Fabric Insert Pilot and Co-Pilot Seat with 6-Way Power Pilot Seat
 Power Steering
 Directional Map Lights on Bottom of Front TV Cabinet
 Color-Coordinated Carpeted Floor Mats

Options

Ultraleather™ Six-Way Power Co-Pilot Seat
 Ultraleather™ Six-Way Co-Pilot Seat with Power Footrest
 Ultraleather™ Extra Wide Co-Pilot Seat with Power Footrest
 Pilot and Co-Pilot Pull-Down Sunshades
 10 Disc CD Changer
 Dash Fans

Appliances & Accessories

Standard Features

Large Double-Door Refrigerator (Norcold® 8 Cu. Ft. 2-Way)
 High-Output 3-Burner Cooktop without Oven
 Removable Solid Surface Range Covers
 Spacesaver Convection Microwave
 24" Flatscreen CRT Color Stereo TV with Remote Control in Living Area
 Living Area Stereo TV Wired through Ceiling Speakers
 20" Flatscreen CRT Color Stereo TV with Remote in Bedroom Area
 TV Antenna with Jacks
 VCR Prep and Video Control Box with Booster
 Exterior Hook-Ups for DSS Dish and Cable
 Digital Satellite System Prep
 Interior Cable TV Hook-Up and Telephone Jacks
 VCR or DVD Player Options to be Wired to Both TV Locations
 Washer/Dryer Prep

Options

Large Four-Door Refrigerator with Ice Maker (N/A with Pantry)
 High-Output Three-Burner Range with Oven
 Combination Washer/Dryer
 DVD Player
 VCR
 Home Theater System with DVD/VCR Player
 26" Flatscreen LCD TV in Living Area
 Exterior Entertainment Center without Label on Door (N/A: 40PAQ)
 Fully Automatic Digital Satellite System

Interior

Standard Features

Vintage Oak Cabinetry
 Raised Panel Hardwood Cabinet Doors
 Hardwood Cabinet End Panels

Refrigerator Raised Panel Hardwood Inserts
 Decorative Wallboard
 Wallpaper Border in Bath
 Self-Supporting Top-Hinged Overhead Storage Doors and Positive Catches on All Other Doors
 Heavy-Duty Ball Bearing Drawer Guides
 Wood Cabinet Drawer Boxes
 Crown Molding in Bedroom and Living Area
 Metal Interior Grab Handle on Dash at Entry Door
 Satin Brass Cabinetry Hardware and Bath Accessories
 Polished Solid Surface Kitchen Countertop with Stainless Steel Sink with Two Sink Covers
 Solid Surface Kitchen Countertop Extension (N/A: 36SKT)
 Silverware Drawer with Organizer in Kitchen Base Cabinets (N/A: 36SKT)
 Tip-Out Tray under Kitchen Sink
 Solid Surface Backsplash in Galley and Bath
 Solid Surface Bathroom Countertop with Integrated Sink
 Solid Surface Nightstand Tops
 Kitchen Overhead Cabinet with Adjustable Shelf
 Roll-Out Pantry next to Two-Door Refrigerator (N/A with Four-Door Refrigerator)
 Wastebasket Storage with Wastebasket
 Sink and Stove Top Cover Storage Area inside Kitchen Base Cabinet
 Ceramic Tile in Kitchen and Bath
 Ceramic Tile in Front of Washer/Dryer Area
 Designer Carpeting in Living Area and Bedroom
 Soft Touch Padded Vinyl Ceiling
 Hardwood Slide-Out Fascia with Decorative Center Block
 Decorative Hardwood/Fabric Window Boxes Throughout Coach
 Hardwood Framed Headboard with Fabric Inserts
 Medicine Cabinet with Two Adjustable Shelves
 Towel Bars on Shower Door

Oversized Rear Closet Wardrobe with Deluxe Decorative Mirrors and Door Frames in Satin Brass

Bedroom Dresser with Solid Surface Countertop

Accent Mirror on Refrigerator Wall (N/A: 36SKT)

Bathroom Lavatory Mirror

Two Towel Rings in Bathroom

Blackout Day/Night Pleated Shades in Living Area and Bedroom

Mini Blinds in Bath

Soil Repellant on Fabric, Teflon® Fabric Protection

Options

Decors: Williamsburg Manor, New Leaf, Kensington Vine, Iron Age

Wood Choice: Autumn Cherry and Maple

Laminate Plank Flooring Kitchen and Bathroom and in front of Washer/Dryer Area

Solid Surface Kitchen Sink

Furniture

Standard Features

Round Hardwood Dinette Table with Two Dinette Chairs and Two Folding Chairs

Roadside Furniture: Fabric DE Sleeper Sofa

Curbside Furniture: Fabric Barrel Chair (36SKT, 40PAQ)

Curbside Furniture: Fabric DE Sleeper Sofa (N/A: 36SKT, 40PAQ)

Queen Bed (60" x 80") with Solid Surface Nightstands

Options

Roadside Furniture: Fabric Hide-A-Bed with Air Mattress

Roadside Furniture: Ultraleather™ Hide-A-Bed with Air Mattress

Roadside Furniture: Fabric Magic Bed Sofa

Roadside Furniture: Ultraleather™ Magic Bed Sofa

Roadside Furniture: Ultraleather™ DE Sofa

Roadside Wraparound Computer Desk with Euro-Recliner with Ottoman (38PDQ, 38PDD, 40PRQ, 40PDQ)

Curbside Furniture: Fabric Hide-A-Bed with Air Mattress (38PDQ, 38PDD, 40PRQ, 40PDQ)

Curbside Furniture: Ultraleather™ Hide-A-Bed with Air Mattress (38PDQ, 38PDD, 40PRQ, 40PDQ)

Curbside Furniture: Fabric Magic Bed Sofa (38PDQ, 38PDD, 40PRQ, 40PDQ)

Curbside Furniture: Ultraleather™ Magic Bed Sofa (38PDQ, 38PDD, 40PRQ, 40PDQ)

Curbside Furniture: Ultraleather™ DE Sofa (38PDQ, 38PDD, 40PRQ, 40PDQ)

Curbside Furniture: Ultraleather™ J-Lounge with Drawer (N/A: 36SKT, 40PAQ)

Curbside Furniture: Fabric Recliner (36SKT, 38PDD, 40PAQ)

Curbside Furniture: Ultraleather™ Recliner (36SKT, 38PDD, 40PAQ)

Curbside Furniture: Ultraleather™ Euro-Recliner with Ottoman (36SKT, 38PDD, 40PAQ)

Adjustable Coffee Table

Pillow Top Mattress

Booth Dinette (N/A: 40PAQ)

Electrical Systems and Lights

Standard Features

50 Amp 12V Distribution Panel and Power Cord

Onan® 8.0 kW Quiet Diesel Generator on Manual Slide-Out

Four 6V Deep Cycle Batteries

Two 12V Heavy-Duty Chassis Batteries

Battery Disconnect Switch at Front Door

Battery Boost Switch in Cockpit

2,000 Watt Inverter

Recessed Docking Lights

Porch Light and Exterior Step Light on Same Switch

Lighted Interior Steps

Lights in Outside Storage Compartments with Switch on Passenger Console and Utility Bay

110V Outlet in Outside Storage Compartment

Underhood Utility Light

Systems Control Center in Hallway

Fluorescent Light(s) under Kitchen Overhead

Fluorescent Ceiling Lights Throughout

Decorative Satin Brass Lighting Package

Fluorescent Ceiling Lights inside Living Area Slide-Out House

Decorative Framed Longer Galley Fluorescent Ceiling Light

Halogen Lights with Dimmer Control under Living Room, Dining Room, Bed Overhead, and Bedroom Dresser Overhead Cabinets

Options

Energy Management System

Auto Generator Start

Solar Panel

Power Cord Reel

Heating, Vents and Air Conditioning

Standard Features

Dual 13.5M BTU Roof Air Conditioner with Ducted Air, Heat Pumps and Digital Thermostat Control

Electronic Ignition Furnace (36SKT, 38PDD) (1) 40M BTU

Dual Zone Electronic Ignition Furnaces (N/A: 36SKT, 38PDD) All Others (2) 25M BTU

Electronic Dash AC/Heat Climate Control System

In-Floor Ducted Heating System

12V Fantastic Attic Fan in Kitchen with Wall Thermostat

12V Roof Vents in Bath Hall and Private Bath

12V Heater in Wet Bay

Metal Floor Registers, Antique Brass

Options

12V Fantastic Attic Fan in Lavatory

Attic Fan with Rain Sensor in Kitchen

Attic Fan with Rain Sensor in Lavatory

Plumbing and LP Systems

Standard Features

Demand Water System and Water Pump

10 Gallon LP Gas/Electric Water Heater with Electronic Ignition DSI Water Heater Located below Floor

Single Lever Sand-Colored Kitchen Faucet with Pullout Sprayer

Separate Brushed Satin Nickel Faucet for Filtered Water

Satin Brass Bathroom Faucet

Satin Brass Shower Faucet

Water Heater Bypass Valve

Water Pump Switch in Hall Systems Panel Center, Private Bathroom Lavatory and Service Bay Area

Thetford China Toilet

Thetford China Toilet Electronic Thetford Silent Plus (40DST)

Shower inside Wet Bay with Hot/Cold Water

No-Fuss Flush Holding Tank Rinsing System

Gravity and Pressurized Water Fill

Insulated Systems Compartment with Easy Access to Hook-Ups

Soap Dispenser inside Utility Bay

One-Piece Fiberglass Shower (N/A: 40DST)

Bathtub (40DST)

Satin Brass Shower Door Frame with Decorative Glass

Options

RV Sani-Con Tank Drainage System

Electric Automatic Winterization

Power Water Hose Reel

Bathtub

Windows, Doors & Awnings

Standard Features

Radius Flush Mount Dual Pane Safety Glass Dark Tinted Windows

Front Entry Door with Removable Screen and Anti-Skid Steps

Exterior Entry Door Grab Handle

Metal Interior Grab Handle on Dash at Entry Door

Color-Coordinated Acrylic Patio Awning
 Topper Slide-Out Awnings Living Area and Bedroom
 Front Door Awning
 Tinted Skylight in Bathroom with Protecta Glaze
 Window Awnings on All Slide-Out House
 Windows except Slide-Out Windows under Patio Awning

Options

Eclipse Automatic Patio Awning
 Bedroom Window Awning on Sidewall (38PDD, 40DST, 40PRQ)
 Keyless Entry (Front Door Only)

Safety

Standard Features

Fire Extinguisher
 Deadbolt Lock on Entrance Door
 120V GFI Protected Circuit
 LP Gas Detector
 Smoke Detector
 Carbon Monoxide Detector
 Driver and Passenger Three-Point Seat Belts
 Third Brake Safety Light
 Egress Window(s)

Chassis/Engine/Suspension

Standard Features

Roadmaster Raised Rail RR8R-Series Chassis
 Aluminum Rear Mount Radiator with CAC Cooler
 Dual Fuel Fill
 160 Amp Alternator
 Rear Axle Ratio: 4.30:1

Goodyear Radial Tires 275/70R/22.5 G670RV
 Stainless Steel Wheel Liners
 Cushion Air Glide Suspension with Eight Outboard-Mounted Air Bags and Eight Monroe Shock Absorbers
 Anti-Lock Braking System with Full Air Brakes
 Automatic Traction Control
 Exhaust Braking System
 Auto Slack Adjusters on Brakes
 Transmission Temperature Gauge
 Air Cleaner Restriction Gauge
 Engine Block Heater
 Fuel and Water Separator
 Remote Transmission Fill
 Rock Shield to Radiator
 10,000 Lb. Hitch Receiver with Seven-Point Connector
 RVA Manual Hydraulic Leveling Jacks

Options

Caterpillar® C-9 400 HP at 2,100 RPM Electronic Engine with Allison® 3000 MH 6-Speed World Transmission and Electronic Shifter
 Torque: 1,100 lbs./ft. Max. Net at 1,400 RPM Engine Displacement 8.8L/537 Cu. In.
 Polished Aluminum Wheels (4)

Weights

Gross Vehicle Weight Rating (Lbs.)

36' SKT	33,000
38' PDQ	33,000
38' PDD	33,000
40' PRQ	33,000
40' DST	33,000
40' PAQ	33,000
40' PDQ	33,000

Gross Combined Weight Rating* (Lbs.)

36' SKT	43,000
38' PDQ	43,000
38' PDD	43,000
40' PRQ	43,000
40' DST	43,000
40' PAQ	43,000
40' PDQ	43,000

Front Gross Axle Weight Rating (Lbs.)

36' SKT	13,000
38' PDQ	13,000
38' PDD	13,000
40' PRQ	13,000
40' DST	13,000
40' PAQ	13,000
40' PDQ	13,000

Rear Gross Axle Weight Rating (Lbs.)

36' SKT	20,000
38' PDQ	20,000
38' PDD	20,000
40' PRQ	20,000
40' DST	20,000
40' PAQ	20,000
40' PDQ	20,000

Measurements

Wheelbase

36' SKT	216"
38' PDQ	242"
38' PDD	242"
40' PRQ	256"
40' DST	256"
40' PAQ	256"
40' PDQ	256"

Overall Unit (Length) (Width) (Height)

36' SKT	37' 0"	100.5"	12' 3"
38' PDQ	39' 4"	100.5"	12' 3"
38' PDD	39' 4"	100.5"	12' 3"
40' PRQ	40' 4"	100.5"	12' 3"
40' DST	40' 4"	100.5"	12' 3"
40' PAQ	40' 4"	100.5"	12' 3"
40' PDQ	40' 4"	100.5"	12' 3"

Interior Height

All Santiam Models 6'7.5"

Interior Width

All Santiam Models 94.5"

Exterior Width

All Santiam Models 100.5"

Tank Capacities

Water Heater

All Santiam Models 10 gal.

Gray Tank

All Santiam Models 62 gal.

Black Tank

All Santiam Models 40 gal.

Fresh Tank

All Santiam Models 100 gal.

Fuel Tank

All Santiam Models 100 gal.

LP Tank**

All Santiam Models 39 gal.

* Towing capacity is limited by GCWR; your vehicle's towing capacity is the difference between the GCWR and the actual vehicle weight, including all water, fuel, passengers and cargo. Your towed vehicle should be equipped with auxiliary brakes if the weight of the towed vehicle exceeds 1,000 lbs. Consult your Owner's Manual for further towing information.

** Actual filled LP capacity is 80% of listing due to safety shut-off required on tank.

Variances in the fabrication and installation of the tanks may

cause the actual "usable capacity" to be greater or less than the capacities designated above.

Due to the large variety of options and floorplan arrangements available to our customers, actual weights for each unit may differ. Beaver Motor Coaches provides a weight sticker on each unit we produce, which includes that unit's tank capacities and approximate weight. Consult your local Beaver Motor Coaches dealer for unit availability and further information. The information printed in this brochure reflects product design, fabrication, and component parts

at the date of printing. The manufacturer reserves the right, at any time, to make changes in product design, material or component specifications as its sole option, without notice. This includes the substitution of components of a different brand or trade name, which will result in comparable performance. All information printed in this brochure is subject to change after the date of printing. Some features shown or mentioned in this brochure are optional and may only be available in selected floorplans. Photographs may show props or decorations that are not standard

equipment on Beaver Motor Coach models. Beaver Motor Coaches, the Beaver logo and its design, are registered trademarks. All other products and company names are trademarks and/or registered trademarks of their respective holders.

The actual overall length of the recreational vehicle may differ from that indicated in the brochure due to variances in the manufacturing process and/or installed components. The actual length may be greater or less than that indicated.