



2004

Explore American Eagle's Features and Benefits.

The Liberty Chassis™ — Enables American Coach to design and manufacture double, triple and quadruple slide-out floor plans. The Liberty Chassis can be paired with either Spartan or Freightliner options. Both options offer a truly unequalled driving experience.

Luxurious Driving Experience — Built on the brand new Liberty Chassis, with Independent front suspension, 4 air bags and 55 – 56 degree cramp angle. This chassis provides the handling and maneuvering our customers are looking for in a Diesel motor home.

Six Interior Decors and Seven Exteriors to Choose From — At NO extra cost to the customer. Our competition cannot make that statement!

One-Piece Windshield Bonded into Steel — Compliment the driving experience with a great view from the drivers seat!

Full Body Exterior Paint — A beautiful exterior from a "state of the art" facility.

A Place for Everything and Everything in its' Place — American Eagle provides storage in the dash, under the galley cabinet, adjustable shelves in the galley overhead, full size pantries, dovetailed drawers with full extension hardware, deep overhead storage, even in the slide-out rooms and a shoe shelf in the ward closet. And that's just inside the motor home! Take a look on the outside. We placed the optional features to maximize the exterior storage. Check the competition to see how they stack up.

82" of Interior Ceiling Height — WOW!

Power — We supply plenty of it. The 40' American Eagle comes equipped with a 400HP Cummins ISL 8.9L engine. The 42' American Eagle is equipped with a 500HP Cummins ISM 10.8L engine. Travel the mountains and valleys and never worry about getting over the next hill.

By Fleetwood — a name you know, a name you trust.

Model 40J

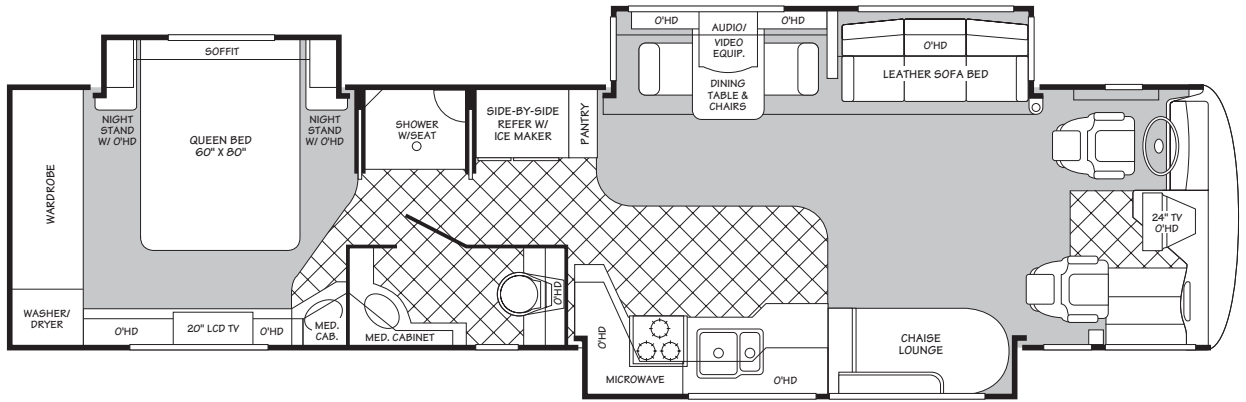

Model 40N

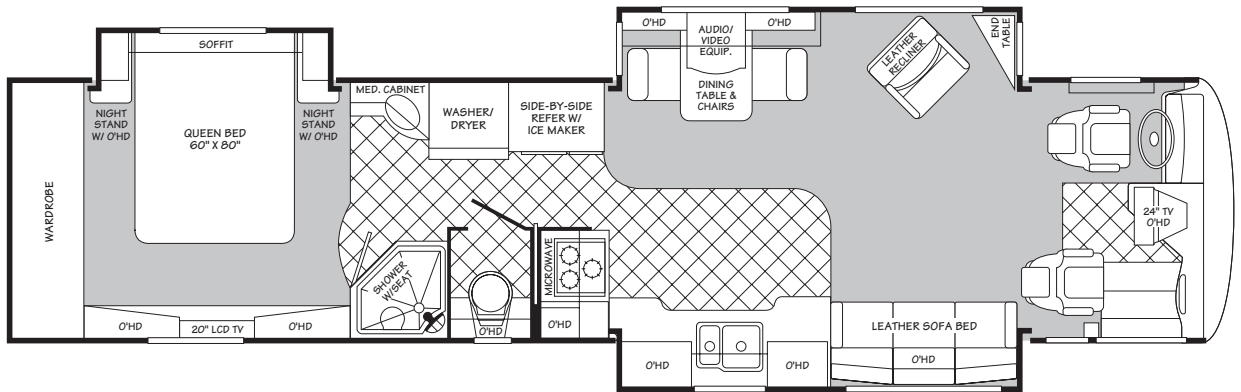

Available Options

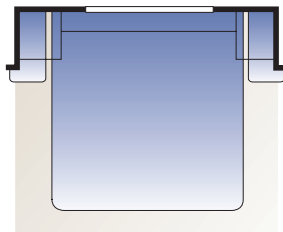

Opt. 852
King Bed 72" x 76"



Opt. 958 Leather
Extra Wide Seat
w/Power Footrest



Opt. 891 Full Rear
Ward or
Opt. 897



Opt. 880 Rear Wall
Shirtward
w/Drawers
or Opt. 894



Opt. 129
Washer/Dryer
Ready



Opt. 111
Ceramic
2-Burner
Cooktop



Opt. 631
Fabric
Ottoman



Opt. 356 Dual 32" Plasma
TV Package



Opt. 629 68" Leather
Chaise Lounge



Opt. 632 68" Fabric
Chaise Lounge
(40N and 40V Only)



Opt. 149
Norcold® 4-Door
w/Ice Maker



Opt. 630
Doorside Overhead

Model 40L

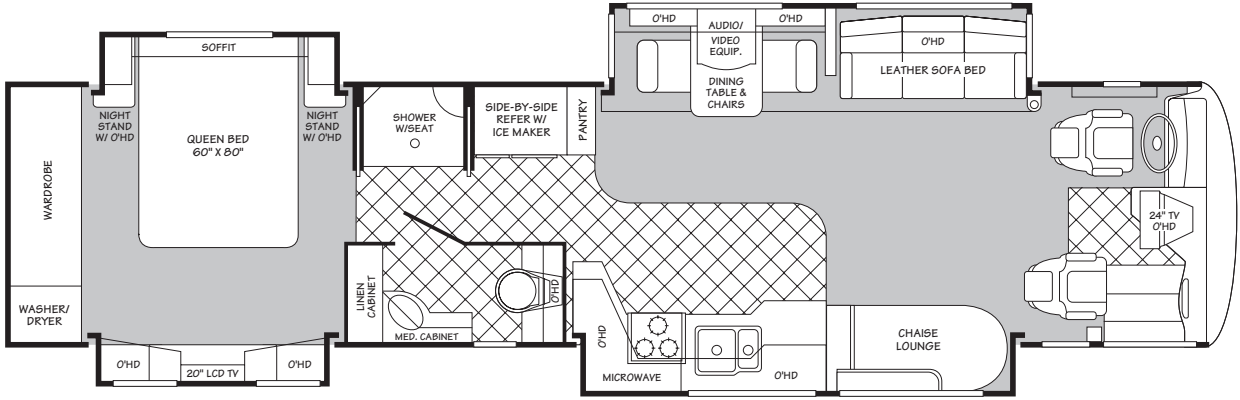

Model 40Q

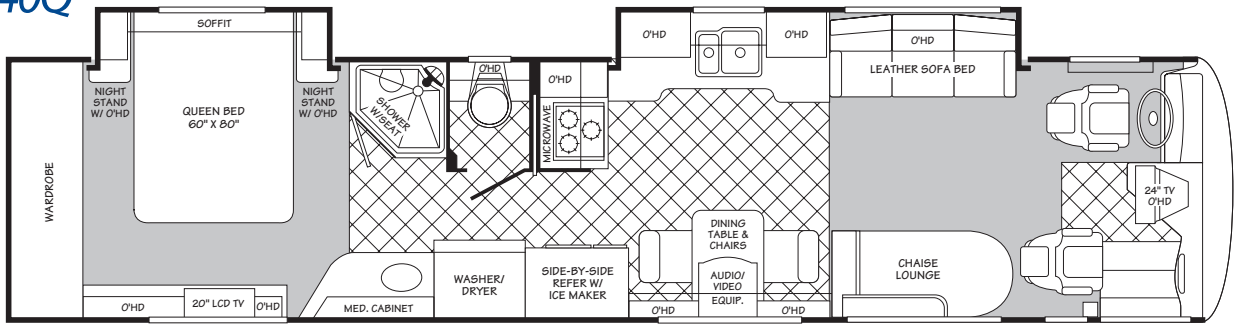

Model 40V

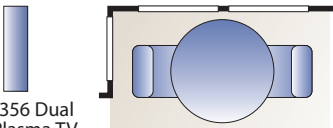
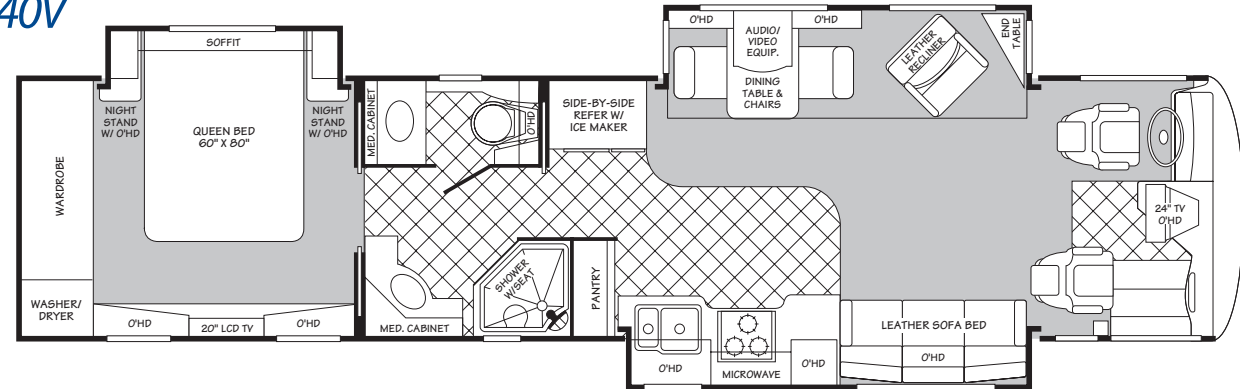

Opt. 356 Dual
32" Plasma TV
Package
(Front End)

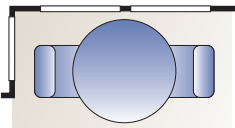

Opt. 831 Free Standing
Dinette w/Bay Windows
(N/A 40Q and 40W)

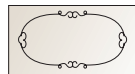

Opt. 904
Inlaid Carpet

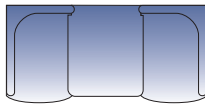

Opt. 830 Upholstered
Facing Dinette Booth
(N/A 40Q and 40W)



Opt. 210 72" Leather
Sofa w/Air Mattress
(N/A 40N, 40Q, 40V
and 40W)

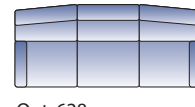

Opt. 628
72" Fabric Sofa Bed
(N/A 40N and 40V)



Opt. 637 68" Leather Sofa
w/Removable Arms
(N/A 40N and 40V)

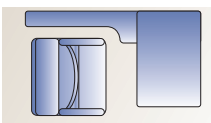

Opt. 870 Desk
w/Leather Recliner
(40L, 40J, 42R and
42Y Only)

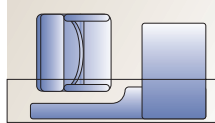

Opt. 870 Desk w/Leather
Recliner and Doorside
Overhead Opt. 630
(40Q and 40W Only)



Opt. 494 Leather
Recliner w/Footrest
and End Table
(40L, 40J, 42R and
42Y Only)

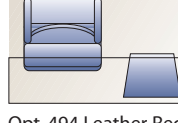

Opt. 494 Leather Recliner
w/Footrest and End Table and
Doorside Overhead Opt. 630
(40Q and 40W Only)



Opt. 211 68"
Leather Sofa
(N/A 40N and 40V)

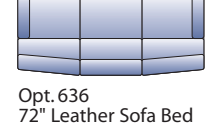

Opt. 636
72" Leather Sofa Bed
w/Removable Arms

Model 40W

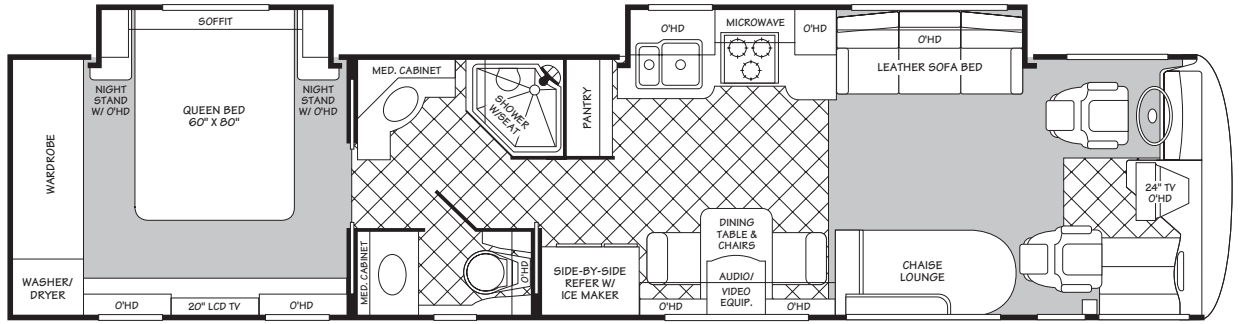

Model 42R

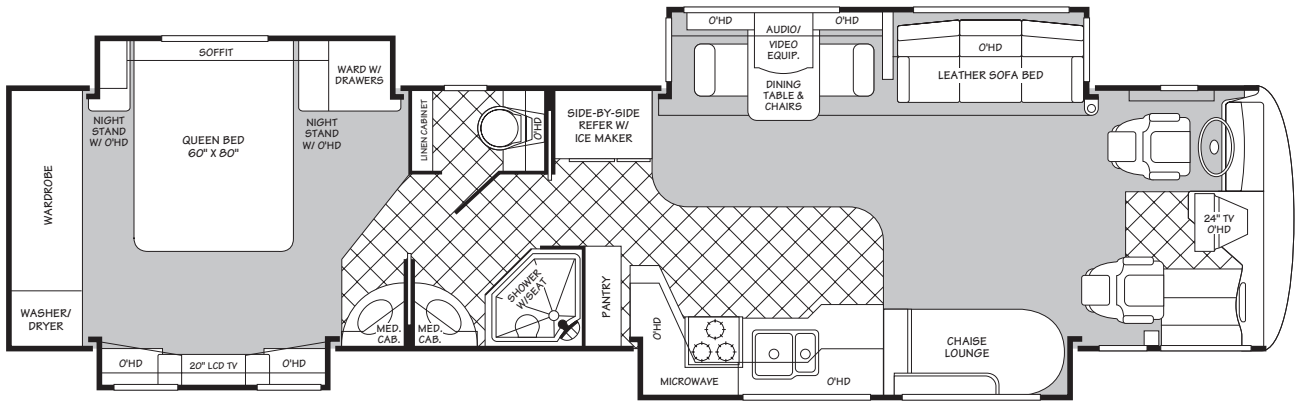

Model 42Y

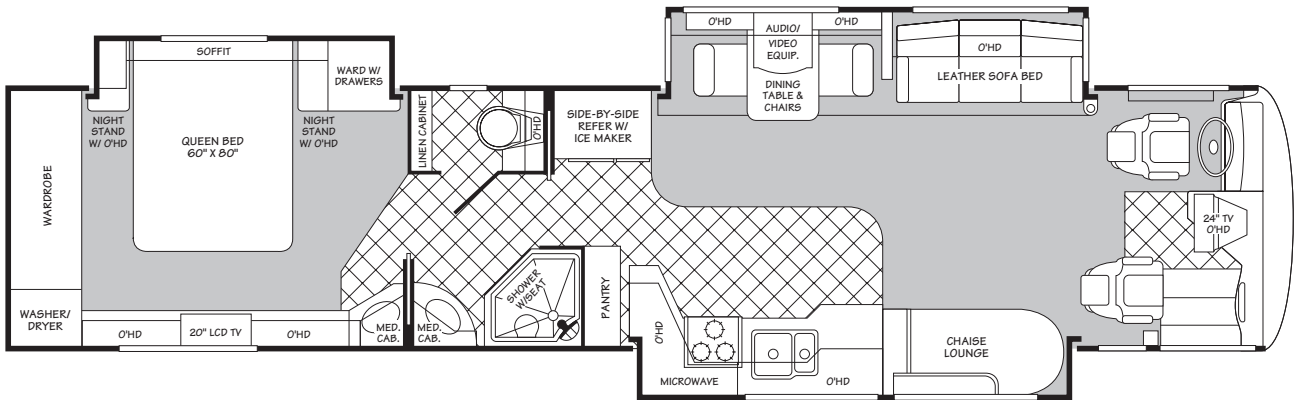

Weights (pounds)	40J	40N	40L	40Q	40V	40W	42R	42Y
GVWR (lbs.)(1)	34,600	34,600	34,600	34,600	34,600	34,600	44,600	44,600
Front GAWR (lbs.)(2)	14,600	14,600	14,600	14,600	14,600	14,600	14,600	14,600
Rear GAWR (lbs.)(2)	20,000	20,000	20,000	20,000	20,000	20,000	20,000	20,000
Tag Axle GAWR (lbs.) (2)	N/A	N/A	N/A	N/A	N/A	N/A	10,000	10,000
Base Weight (lbs.)(3)	29,200	29,650	29,950	28,200	29,650	28,400	34,400	34,100
GCWR (lbs.)(4) Spartan®	49,600	49,600	49,600	49,600	49,600	49,600	59,600	59,600
GCWR (lbs.)(4) Freightliner®	46,600	46,600	46,600	46,600	46,600	46,600	N/A	N/A
Hitch Rating Weight (lbs.)* Spartan®	15,000	15,000	15,000	15,000	15,000	15,000	15,000	15,000
Hitch Rating Weight (lbs.)* Freightliner®	12,000	12,000	12,000	12,000	12,000	12,000	N/A	N/A
Tongue Weight (lbs.)* Spartan®	1,500	1,500	1,500	1,500	1,500	1,500	1,500	1,500
Tongue Weight (lbs.)* Freightliner®	1,200	1,200	1,200	1,200	1,200	1,200	N/A	N/A

Measurements

Wheel Base	266"	266"	266"	266"	266"	266"	290"	290"
Overall Length (5)	39'-11.5"	39'-11.5"	39'-11.5"	39'-11.5"	39'-11.5"	39'-11.5"	41'-11.5"	41'-11.5"
Overall Height w/AC	12'-8"	12'-8"	12'-8"	12'-8"	12'-8"	12'-8"	12'-8"	12'-8"
Overall Width (max) (6)	101.5"	101.5"	101.5"	101.5"	101.5"	101.5"	101.5"	101.5"
Interior Height (max)	82"	82"	82"	82"	82"	82"	82"	82"
Interior Width (max)	96"	96"	96"	96"	96"	96"	96"	96"

Tank & Liquid Capacities (gallons)

Fresh Water Holding Tank (gal.)	95	95	95	95	95	95	120	120
Grey Water Holding Tank (gal.)	70	70	70	70	70	70	60	60
Black Water Holding Tank (gal.)	40	40	40	40	40	40	40	40
Appliance LP Gas Tank (WC) (7)	38	38	38	38	38	38	38	38
Water Heater Tank (gal.)	10	10	10	10	10	10	10	10
Fuel Capacity (gal.)	125	125	125	125	125	125	125	125

Liquid Weight Reference: Water (gal) = (8.3 lbs/3.8 kgs) Fuel (gal) = (7.1 lbs/3.2 kgs) LPG (gal) = (4.2 lbs/1.9 kgs)

Metric Conversion: Multiply pounds x 0.453 to obtain kilograms Multiply gallons x 3.785 to obtain liters

Chassis Frame Engine Torque Transmission	40 Ft. Models Liberty Chassis™ Cummins® 8.9L, 400 hp ISL Diesel 1200 lb. ft. at 1300 RPM Allison® 3000 MH, 6-Speed w/Electronic Shifter
Alternator Amps Tires	200 Amp Leece-Neville 295/80R 22.5LRH L Radial

Chassis Frame Engine Torque Transmission	42 Ft. Models Liberty Chassis™ Cummins® 10.8L, 500 hp ISM Diesel 1550 lb. ft. at 1200 RPM Allison® 4000 MH, 6-Speed w/Electronic Shifter
Alternator Amps Tires	200 Amp Leece-Neville 295/80R 22.5LRH L Radial

1. GVWR (Gross Vehicle Weight Rating): Means the maximum permissible loaded weight of the motor home. The GVWR is equal to or greater than the sum of the unloaded vehicle weight plus the net carrying capacity.
2. GAWR (Gross Axle Weight Rating): Means the maximum permissible loaded weight a specific axle is designed to carry.
3. Base Weight: Means the estimated weight of the motor home without fuel, options, water, cargo or passengers.
4. GCWR (Gross Combined Weight Rating): Means the value specified by the motor home manufacturer as the maximum allowable loaded weight of this motor

home with its towed vehicle. Towing and braking capacities may differ. Refer to Fleetwood and chassis manufacturer manuals for complete information.

5. Length taken from front bumper to rear bumper (excludes accessories).
 6. Excludes safety equipment and awnings.
 7. Tank Manufacturer's listed water capacity (WC). Actual LPG capacity is 80% of water listing as required by the safety code.
- * The chassis manufacturer recommends the installation of a supplemental brake control system to activate the brakes on the vehicle or trailer you are towing.

IMPORTANT — PLEASE READ: Product information, photography and illustrations included in this publication were as accurate as possible at the time of printing. For further product information and changes, please visit our website at www.fleetwoodrv.com or contact your local Fleetwood dealer. Prices, materials, design and specifications are subject to change without notice. All weights, fuel, liquid capacities and dimensions are approximate. Fleetwood has designed its recreational vehicles to provide a variety of uses for its customers. Each vehicle features optimal seating, sleeping, storage and fluid capacities. The user is responsible for selecting the proper combination of loads (i.e. occupants, equipment, fluids, cargo, etc.) to ensure that the vehicle's capacities are not exceeded.

Standard Features

Automotive

- Liberty Chassis™ by American Coach™
- Allison® 3000 MH, 6-Speed Automatic Transmission (w/400 HP Engines)
- Allison® 4000 MH, 6-Speed Automatic Transmission (w/500 HP Engines)
- Jacobs® 2-Stage Engine Compression Brake (Hi-Lo)

Exterior Automotive

- Undercoating
- Auxiliary Fog Lamps
- Docking Lights (2) Each Front and Rear
- (6) Aluminum Wheels (4 Polished, 2 Non-Polished) 40' Models
- (8) Wheels (6 Aluminum & Polished, 2 Steel) 42' Models
- Anti-Lock Brake System (ABS)
- Radial Tires
- Tire Pressure Check Gauge
- 4-Point Automatic Leveling Jacks
- Chrome "Bus-Like" Heated Mirrors w/Remote Adjustment and Turn Signal Indicators
- Large 50" One-Piece Bus Style Windshield
- Hadley® Air Horns
- Utility Light, Front and Rear
- Sound Insulation in Sub Floors, Front & Rear
- Steel Surface on Front Bulkhead/Engine Frame
- (4) 12V Maintenance Free AGM® House Batteries (Group 27)
- (2) 12V Chassis Batteries—2000 CCA
- Electronic Battery Control Center
- Trailer Hitch Receiver 12,000 LBS/Freightliner®
- Trailer Hitch Receiver 15,000 LBS/Spartan®
- Chrome Hitch Cover, Pin and Clip®
- Daytime Run Lights

Interior Automotive

- Battery Disconnects
- Driver/Passenger Map Lights
- Passenger Drink Holder
- Corian® Drink Holder
- Pneumatic Step Well Cover
- Rear Vision System w/Audio (Camera & Monitor)
- Visteon® AM/FM & Single CD/Cassette—Dash
- (2) Auxiliary 12V Dash Receptacles
- Interior Wall Mounted Grab Bar
- Back Lighted Instrument Panel
- Denso™ Climate Control System
- Adjustable Pedals
- Tilt/Telescope Steering Wheel
- Smart Wheel w/Burl Wood
- Power Driver/Passenger Sun Visors
- Driver Side Pull Down Shade
- Power Driver Window
- Intermittent Wipers (Single Motor)
- Cruise Control
- I.C.C. Light Switch
- Remote Auxiliary Start Switch
- Manual Air Dump Override Switch
- Flexsteel® Leather 6-Way Power Driver Seat w/Heat/Power Lumbar

- Flexsteel® Leather 6-Way Power Passenger Seat w/Heat/Power Lumbar/Electric Footrest
- Compass & Exterior Temperature Gauge

Structural

- Liberty Chassis™ (Patent Pending)
- E-Coated Steel Structure (Below Floor)
- Lightweight Aluminum Construction (Hull)
- Interlocking Extrusions
- Vacu-Bond® Sidewall, Roof & Floor Construction
- Heated Water & Holding Tank Compartments
- Insulated Storage Area
- Vacu-Bond® Walls w/Smooth Exterior Skin
- Bonded One-Piece Windshield w/Steel Frame

Exterior

- Full Fiberglass Front & Rear Caps
- One-Piece Domed Fiberglass Roof
- Gelcoat Fiberglass Exterior Sidewalls
- Fiberglass Front Quarter Panels/Wheel Trims
- Protective Vinyl Front Cover
- Powered Generator Slide-Out
- Polished Stainless Steel Bumpers—Front & Rear
- Large Windshield Washer Bottle w/Adjustable Sprayer Nozzles
- Power Double Entry Step w/Last Out Feature
- 30" Front Entry Door w/Dead Bolt & Pneumatic (Air) Lock
- Deluxe Lighted Exterior Entry Handle w/Logo
- Entry Door Awning
- Keyless Entry Door w/Key Fob
- Entry Screen Door
- Stainless Brushed Polished Kick Plate Under Entry Door
- Exterior Graphics
- Window Awnings (Bedroom & Front Roadside Windows)
- Electric Patio Awning
- Large Passenger Window
- Dual Pane Windows w/Screens
- Color Coded Awnings & Awning Arms
- Mud Flaps Front & Rear
- Floor Mounted LP Gas Tank, 38 Gallons
- Patio Receptacles
- Full Width Rear Rock Guard w/Logo
- Power Luggage Door Locks w/Key Fob
- (4) 12V Electrical Outlets in Exterior Luggage Compartments Near Each Corner of Coach
- (4) Turn Signal Repeaters Per Side of Coach
- Luggage Compartment Lights
- Porch Light (1)
- Exterior Storage Doors w/Pantograph Hinges (Selected Models)
- Exterior Flip-Up Storage Doors w/Lockable Latch System
- Gas Struts on All Luggage Doors (Selected Models)
- Variable Speed Aqua Tec Water Pump
- Whole Coach Water Filter System
- Tank Level Monitor (Interior/Exterior)
- Water Heater By/Pass Check Valve
- 25' Fresh Water Hose

- Fresh Water Gravity Fill
- Water Pump Switch
- Holding Tanks w/Low Point Drain Valves
- Exterior Convenience Light at Dump Valves
- Dual Holding Tank San-T-Flush System
- Exterior Rinse Hose w/Soap Dispenser & Paper Towel Holder
- Integrated Upper Fiberglass Wing Deflector
- 50 Amp Power Cord Reel
- 50' Air Service Line
- Two Piece Rear Ladder
- Rear Access Door Storage Boxes (42' Models Only)

Interior

- Front Windshield Privacy Curtain
- Porcelain Diagonal Tile at Front Entry
- Entry Step Switch at Entry Wall
- Interior Multi Plexed Switches
- Vinyl Padded Ceiling w/Decorative Air Plenum and Indirect Lighting
- Deluxe Padded Window Treatments
- Day/Night Pleated Shades
- 12V Halogen Ceiling Lighting System
- Dimmer Switch in Living and Bedroom Areas
- Rain Sensor Power Roof Vents w/3-Speed Fan
- Tuff-Pex™ Plumbing System
- Washer/Dryer (Vented)
- Skylight Cover (Selected Models)
- Lined Shelves
- Eureka® Portable Vacuum Cleaner
- Centralize Control Panels Display Center
- Multi-Plexed Slide-Out Control Switches
- Interior Assist Handle

Cabinetry

- Walnut, Regency Cherry, Clear White Maple or Butterscotch Cabinetry
- Hardwood Front TV Overhead
- Solid Hardwood Drawers w/Dovetail Joints
- Ball Bearing Drawer Guides w/Full Extension Hardware on All Drawers
- Solid Core Raised Panel Cabinet Doors
- Cedar Lined Wardrobe

Galley

- Silverware Tray
- Corian® Dinette Table w/Slide-out & (4) Decorative Chairs
- Large Solid Surface 60/40 Double Bowl Galley Sink
- Delta® High Rise Galley Faucet
- Brushed Chrome Soap Dispenser
- Corian® Galley Top & Sink Covers
- Recessed 3 Burner Range w/Oven w/Brushed Aluminum Finish
- Corian® Range Cover
- Storage for the Corian® Galley and Range Tops
- GE® Advantium Microwave/Convection Oven w/Brushed Aluminum Finish Built-In Range Hood w/Light/Fan
- Dometic™ 120V/LP Gas 12 Cu. Ft. Side By Side Refrigerator w/Icemaker/Brushed Aluminum Finish
- Decorative Mirrors—Backsplash
- Dinette Base Cabinet w/Storage
- 120V Outlet & Telephone Jack at Dinette

- Porcelain Tile Floor (Diagonally Laid)
- Skylight in Shower
- Brass/Bronze Bath

Accessories

- Corian® Lavy Top w/Corian® Sink and Delta® Faucet
- Medicine Overhead Cabinet
- Fiberglass Shower enclosure w/Molded Seat (Selected Models)
- Corian® Molded Shower Caddy (Selected Models)
- Shower Doors w/Positive Latch
- Moen® Hand Held Shower Head
- Residential China Bowl Flush Toilet w/Hand Sprayer
- Porcelain Tile Floor (Diagonally Laid)
- Padded Fabric Headboard
- 60" x 80" (Full Queen Size) Innerspring Padded Pillow Top Mattress
- Key Locked Safe
- Day/Night Pleated shades
- Hand Laid Wallpaper w/Decorative Border
- Solid Wood 6-Panel Bath/Bedroom Doors
- 120V/12V AC/DC Central Electrical Panel
- Corian® Nightstand Tops
- Generator Start/Stop Switch in Bedroom
- Shoe Storage in Ward Closet
- Wardrobe Light
- Secondary Phone Jack

Furnishings

- Flexsteel® Fabric Chaise Lounge (Select Models)
- Flexsteel® Leather Sofa Bed
- Flexsteel® Leather Recliner (Select Models)

Entertainment

- 24" Sony® Vega TV w/Remote (Front)
- 20" LCD TV w/Remote (Rear)
- Sony® VHS—4 Head Hi-Fi Stereo VCR
- KVH Domed Digital Satellite System
- Sony® Home Theater System (Includes CD/DVD Player)
- Pre-Programmed Universal Remote Control (Controls ALL Electronics)
- TV Cable Ready
- Park Telephone Ready
- Power TV Antenna w/Warning Alarm and (2) Jacks

Coach Support Systems

- Onan® 7.5 kw Quiet Diesel Generator w/Power Slide-Out (40' Models)
- Onan® 10 kw Quiet Diesel Generator w/Power Slide-Out (42' Models)
- Automatic Generator Start Switch
- Energy Management System
- Trace® RV Series 2500 Watt Continuous Inverter (130 Amp Converter)
- RC7® Battery Monitor
- Multi-Point Water Pump Switching System
- D.S.I. 10 Gallon Water Heater 120V/LP Gas
- Whole House Surge Protector
- Solar Charging Panel
- (2) 13.5 M Low Profile Roof Air Conditioners w/Heat Pump (40' Models)
- (3) 13.5 M Low Profile Roof Air Conditioners w/Heat Pump (42' Models)
- Dual 2-Stage High Efficient Furnaces w/Thermostat & Auto Ignition (15/22 M / 23/34 M)
- Furnace Ducting System

Safety

- LP Gas Leak Detector/Alarm
- Smoke Detector/Alarm
- Fire Extinguisher
- Integrated Seat Belts/Driver and Passenger Seats
- Back-Up Alarm
- Carbon Monoxide Detector/Alarm

Options

Automotive

- Air Ride Suspension w/Sachs® Shocks/Freightliner®
- Air Ride Suspension w/Bilstein® Shocks/Spartan®
- Freightliner® ZF Option w/400 HP Cummins® ISL Engine (40' Models)
- Spartan® IFS Option w/400 HP Cummins® ISL Engine (40' Models)
- Spartan® IFS Option w/500 HP Cummins® ISM Engine (42' Models)
- CSA Freightliner® Package (40' Models)
- CSA Spartan® Package (40' Models)
- Upper Cap Transition Panels

Exterior Automotive

- Air & Hydraulic Leveling System
- Security Vision w/(2) Cameras

Interior Automotive

- Back Lighted Instrument Panel
- Denso™ Climate Control System

- Visteon® AM/FM CD-6 Radio In Dash
- CB Radio Ready (Power and Antenna)
- Satellite Radio
- GPS® Navigation System (Integrated Into the Sony® Back-Up Monitor)
- Night Vision®—Raytheon
- Trip Tek
- On-Star® Navigation System
- Flexsteel® 6-Way Power Passenger Extra-Wide Seat w/Heat Power Lumbar/Electric Footrest

Exterior

- Spot Light
- Lexan® Front Acrylic Shield
- Girard Electric Awning Package (All Electric—Bedroom, Front Roadside & Patio)
- "A" Tray Package (2) 90" (Not Available on 42' w/Hydro Hot) **
- "B" Tray Package (2) 54" & (2) 36" (Not Available on 42' w/Hydro Hot) **
- "C" Tray Package (1) 90", (1) 54", (1) 36" (Not Available on 42' w/Hydro Hot) **
- "D" Tray Package (1) 54", (1) 36" (Not Available on 42' w/Hydro Hot) **
- "E" Tray Package (1) 90" & (1) 54" (Available w/Hydro Hot Only) **
- Front Mask Delete
- Norcold® 12V/120V Chest Refrigerator/Freezer AC/DC
- Power Water Hose Reel

Interior

- Doorside Overhead Cabinet
- Fabrica® Inlaid Carpet—Living Room

- Hydronic® Heating System (2 Zone)
- Central Vacuum System w/Tool Kit
- Washer/Dryer Ready (Delete W/D, Add 2 Shelves)
- V.I.P. Delivery

Galley

- "Insta-Hot/Cold" Water Dispenser
- Recessed Kitchen Aid® 2-Burner Cook Top
- Norcold® 120V/LP Gas 12 Cu. Ft. (4) Door Refrigerator w/Icemaker/Brushed Aluminum Finish
- Galley to Entry Tile Flooring (Fabrica® Area Rug Included w/Option/Carpeting Under Flush Floor Area)
- NuHeat® Heated Tile Floor

Bath

- NuHeat® Heated Tile Floor
- Obscure Shower Enclosure

Bedroom

- Shirt ward w/Drawers at Rear Wall
- Ceiling Fan 12V
- King Bed (72" x 76")
- Full Length Wardrobe at Rear Wall

Furnishings

- Flexsteel® Leather Sofa Bed w/Air Mattress (Bed 60" x 80")
- Flexsteel® Free Standing Leather Recliner w/Footrest (Includes End Table) (Standard on 40N and 40V Models)
- Flexsteel® Fabric Sofa Bed (Replaces Leather Sofa)

- Flexsteel® Leather Chaise Lounge (Replaces Fabric Chaise Lounge)
- Flexsteel® 68" Leather sofa (Replaces Chaise Lounge)
- Fabric Ottoman (Leather Ottoman N/A)
- Leather Sofa w/Removable Arms
- Leather Loveseat w/Removable Arms
- Desk w/Flexsteel® Leather Recliner
- Facing Dinette (New Design/ Upholstered Booth w/Storage/No Additional Sleeping)
- Free Standing Dinette w/Bay Windows

Entertainment

- Dual 32" Plasma TV Monitors w/Remote (DSS Upgraded to "In-Motion"/Fixed Locations for both TV's/Second Receiver & Home Theater Included)
- Exterior Entertainment Center (24" Sony® Vega TV w/Swivel Slide Tray) (Location is Under S/O Box on Certain Models)

Coach Support Systems

- PowerTec® 8.0 kw Diesel Generator w/Power Slide-Out (40' Models)

* The chassis manufacturer recommends the installation of a supplemental brake control system to activate the brakes on the vehicle or trailer you are towing.

** Must select tray package.

American Coach™ is proud to offer the new Liberty Chassis™ On all 2004 Models.

The Liberty Chassis is unlike any other chassis on the road today. American Coach developed the Liberty Chassis with strength and rigidity to dramatically improve ride and handling. The new chassis design enables us to offer floor plan designs with triple and quad slide-outs along with the many features listed below:

A. Huge Towing Capacity

- 12,000 lb. or 15,000 lb. hitch

B. Laminated Storage Liners

- Easy to Maintain, Neat, Clean Look, Durable

C. E-Coated Structure

- Protects Against Corrosion
- Longevity, Quality and Workmanship

D. All Steel Structure

- Minimize Flex, Enhances Driving Experience, Longevity, Strength

E. Center Mounted Fuel Tank

- Increased Storage Capacity from Previous Platform

F. Independent Front Suspension

- Optimum Handling, Enhances Driving Experience

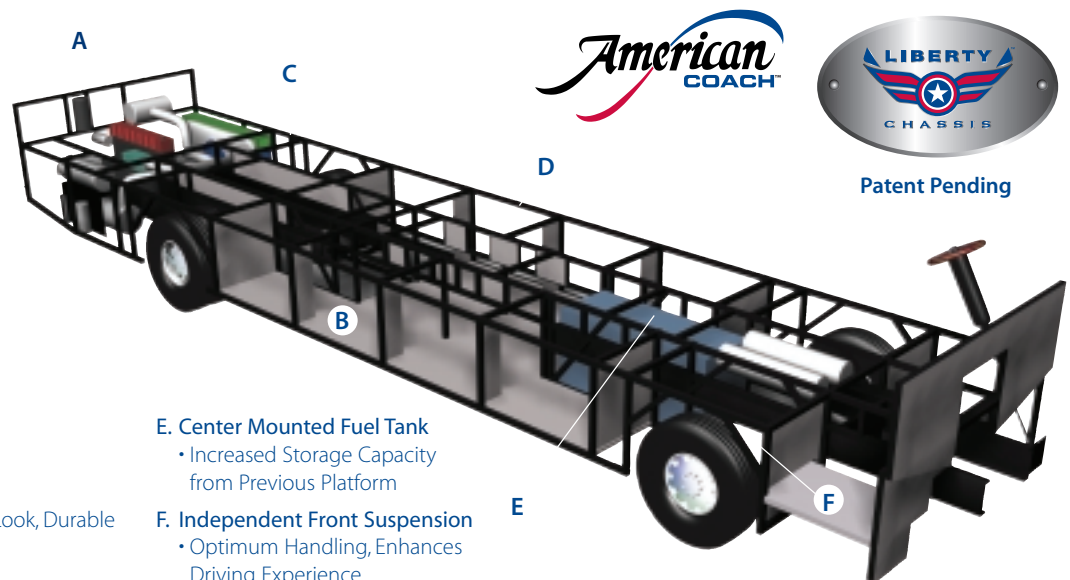

Visit your local American Coach dealer and take a test drive to experience the Liberty Chassis difference for yourself.



RV OWNERCARE...

is a limited one-year/three-year or 15,000 mile warranty, whichever occurs first, and it is fully transferable for the first 12 months.



RV OWNERCARE is one of the RV industry's most comprehensive programs and includes systems, appliances, components, and construction, with no deductible and no service charge.

RV OWNERCARE coverage is provided from a company that will be around in the future to service your needs. See your nearest Fleetwood dealer for a full explanation of benefits and restrictions.

Club Fleetwood...

As a Fleetwood owner, you're eligible to become a member of our owners group, Club Fleetwood. It's a perfect way to meet other Fleetwood owners who love to travel to beautiful resorts and vacation spots all across America. Call (877) 577-2560 and join the fun!



What Drives You?

Maybe it's feeling like you're the only one on Earth. Perhaps it's the unique sense of closeness with the great outdoors. Or, it might be the joy that comes from spending quality time with family and friends.

Whatever the reason, we know that you have a strong drive to experience everything that comes with spending time on the road. And for more than 50 years, we've shared that passion with you.

Because we're RV enthusiasts ourselves, you can see our passion in the vehicles we design and build. Own a Fleetwood, and you'll feel like you're not just traveling, but embarking on an experience unlike any other.

Set your own course for adventure and get out there and explore the world around you. Once you do, you'll see what it is that drives us — it's you.



Your local American Coach dealer is:

www.americancoach.info Visit our website to find a dealer near you or learn more about other Fleetwood products. Or call 1-800-444-4905.



IMPORTANT—PLEASE READ: Product information, photography and illustrations included in this publication were as accurate as possible at the time of printing. For further product information and changes, please visit our website at www.fleetwoodrv.com or contact your local Fleetwood dealer. Prices, materials, design and specifications are subject to change without notice. All weights, fuel, liquid capacities and dimensions are approximate. Fleetwood has designed its recreational vehicles to provide a variety of uses for its customers. Each vehicle features optimal seating, sleeping, storage and fluid capacities. The user is responsible for selecting the proper combination of loads (i.e. occupants, equipment, fluids, cargo, etc.) to ensure that the vehicle's capacities are not exceeded.