

2 0 0 7



*Tropi-Cal LX*





**✓ EXPERIENCE THE NATIONAL RV ADVANTAGE!**

We build every National RV to far surpass the competition in every aspect. Look for this banner throughout the following pages for more information on important items that help make up The National RV Advantage.

## LIVING SPACE

Tropi-Cal LX is the modestly priced diesel motorhome with many luxury appointments usually found on much more expensive highline motorcoaches. Richly appointed interiors feature a choice of three fabulous décors: *Sydney* (shown here), *Capri* or *Dakkar*. To complement these sumptuous interiors, choose from natural maple (shown here), natural cherry or stained cherry wood finishes. A variety of comfortable floorplans range in length from 35 to 39 feet and boast up to four spacious slide-outs. See the back page of this brochure for fabric samples from each décor.



Main: T391 • Sydney • Natural Maple  
Below: T350 • Capri • Stained Cherry

*This is Living!*

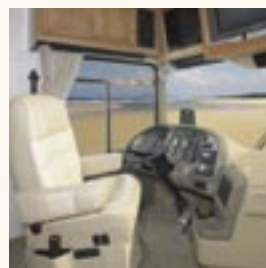

# KITCHENS

Cooking enthusiasts will fall in love with Tropi-Cal LX's fully-equipped kitchen, featuring all of the luxuries of home to make fine meal preparation efficient and enjoyable. A variety of floorplans provide several spacious kitchen configurations to choose from, all featuring an expansive counter topped with genuine Corian®. The huge 12 cubic foot side-by-side refrigerator with ice maker provides plenty of cold storage for lengthy stays. A versatile convection microwave makes heating up a snack or baking a full-course meal quick and easy. Residential quality cabinetry features solid wood cabinet doors and drawer fronts as well as stainless steel ball bearing drawer guides and premium hardware. Hand-laid ceramic tile flooring is both functional and beautiful.



Main: T350 • Capri • Stained Cherry  
Below: T391 • Sydney • Natural Maple



*Just Like Home*



**✓ ANOTHER NATIONAL RV ADVANTAGE!**

**GENUINE CORIAN®**  
Tropi-Cal LX features genuine Corian® solid surface materials on the kitchen counter top and bathroom lavatory cabinet top. Other manufacturers cut costs by using imitation materials or laminates cleverly disguised with solid edge moldings. But we insist on the real thing. Nothing is as durable, impervious to stains and resistant to scratching than genuine Corian®.





**✓ ANOTHER NATIONAL RV ADVANTAGE!**

**ONE-PIECE FIBERGLASS SHOWER**

Manufactured "in-house" at National RV to ensure quality, this shower is crafted of thick fiberglass with plenty of reinforcement for a sturdy, rigid feel. Step into a competitor's shower and you'll feel the difference as the plastic or lower quality fiberglass shower pan gives under your weight. One-piece construction means there are no seams in the shower enclosure where leaks can develop or mold and mildew can thrive. Built for years of trouble-free use, our one-piece reinforced fiberglass shower is truly a National RV Advantage!



## MASTER SUITE

Every Tropi-Cal LX bedroom features National RV's exclusive *Sandpiper Deluxe* true queen-sized pillow top comfort mattress. Huge wardrobes, cabinets, drawers and under-bed storage provide plenty of space for long trips. Each model is available with an optional washer-dryer.

Tropi-Cal LX's open bathroom configurations are spacious and thoughtfully arranged with private toilet rooms. Most models feature his and hers wash basins. All feature National RV's coveted one-piece, reinforced fiberglass shower.



Main: T370 • Dakkar • Natural Cherry  
Below left: T350 • Capri • Stained Cherry  
Below right: T391 • Sydney • Natural Maple

### *Rest Area Ahead*



# E X T E R I O R

Tropi-Cal LX's bold exterior styling makes a statement wherever you go. Lustrous full body paint is available in a choice of three color palettes. Polished aluminum wheels and black exterior hardware complete the distinctive exterior appearance. The raised rail Freightliner XC chassis yields a huge, flat-floor pass-through basement compartment with plenty of storage room for the necessities of extended travel. Exterior utility compartments are accessible and thoughtfully arranged for ease of use.



**Main:** T391 • Copri  
**Below:** Plumbing service compartment



*Your Private Oasis*





**✓ ANOTHER NATIONAL RV ADVANTAGE!**

**DURASLIDE™ FLUSH WALL SLIDE-OUT SYSTEM**

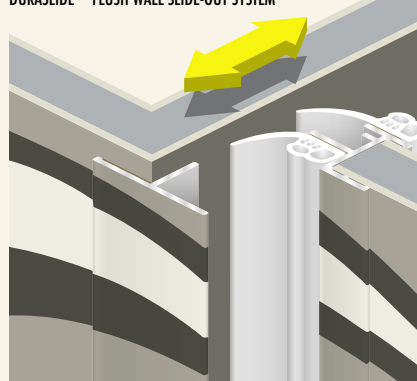

National RV's exclusive DuraSlide™ flush wall slide-out system provides more than just great looks. It is a testament to the engineering and quality manufacturing that go into every National RV motorhome.

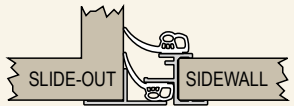

**FLUSH EXTERIOR SURFACE WITH SLIDE-OUT CLOSED**

With the slide fully retracted, the side of the coach has a smooth, flush surface at the slide-out seal. Double wipers with integrated bulb seals provide a positive seal even when the slide-out is in motion, keeping the weather outside and your cozy climate inside.

**WHY DON'T ALL MOTORHOMES COME WITH FLUSH SLIDE-OUT SEALS?**

National RV's careful engineering and tight manufacturing tolerances are what make the flush slide-out seal possible. The system depends on the rigid coach framework that National RV's DuraFrame® and tubular steel coach body framework provides.

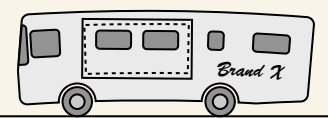

Manufacturers who cut costs by building cheaper, less rigid motorhomes need to hide the resulting gaps and poorer fit by using a wide, protruding cover along the slide-out seams.

**✓ ANOTHER NATIONAL RV ADVANTAGE!**

**INSULATED BASEMENT COMPARTMENTS**

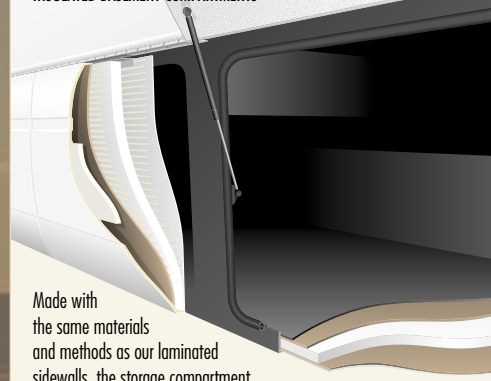

Made with the same materials and methods as our laminated sidewalls, the storage compartment floor panels and door inserts of every National RV motorhome are laminated with highly efficient EPS block foam insulation to keep your valuables safe from temperature extremes.

# DURAFRAME®

Every great home needs a solid foundation, and that's exactly what National RV's DuraFrame® Chassis System and all-steel tubular coach body construction provide. The DuraFrame® is specifically engineered to provide the strength that today's multiple slide-out motor homes require—all within the chassis system itself. DuraFrame®'s all steel, full welded system of tubular steel risers, plate steel outriggers and truss-like engineering provide an abundance of coach strength while enabling cavernous basement storage spaces. Other manufacturers rely on the coach sidewalls to absorb much of the stresses of travelling and bearing the coach's weight. DuraFrame® provides all of the strength necessary to support the coach within the structure itself—below the floor line and below the slide-outs.

## *Cold Hard Steel*



### CHASSIS SPECIFICATIONS

Chassis	Freightliner® XC (raised rail)
Tires	275/70R 22.5H
Wheels	Polished aluminum front and outer rear wheels, steel inner rear wheels with valve extensions
Brakes	Full air brakes with Anti-lock Braking System (ABS)
Suspension	Neway full air ride suspension with manual air dump
Drive Axle Ratio	4.78:1
Fuel Capacity	100 gallons
Hitch	10,000 lbs. class IV with 7-pin electrical connector
Alternator	Leece-Neville 160-amp
Chassis Warranty	3 years/50,000 miles



### DRIVETRAIN SPECIFICATIONS

Engine	Caterpillar® C7 turbodiesel
Displacement	7.2 liters
Peak Horsepower	350 HP @ 2,400 RPM
Peak Torque	860 lbs./ft. @1,440 RPM
Exhaust Brake	Pac Brake®
Engine Warranty	5 years/200,000 miles
Transmission	Allison MH3000
Transmission Type	6-speed automatic with overdrive
Shifter	Touch-pad electronic shifter with digital display
Transmission Warranty	5 years/200,000 miles

### ✓ ANOTHER NATIONAL RV ADVANTAGE!

#### REVOLUTIONARY NEW VIBRATION ISOLATION SYSTEM

Rather than being rigidly welded directly to the chassis frame rails, Tropic-Cal's DuraFrame® and coach body structure rides on a series of elastomeric body mounts which isolate the coach body from much of the noise, vibration and harshness generated while traveling on the road. This system is designed to reduce noise and vibration while improving handling and increasing the life expectancy of coach body components. Take a test drive in a Tropic-Cal LX—you will hear and feel the difference!

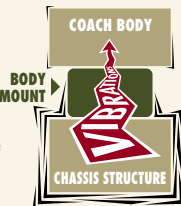

✓ **ANOTHER NATIONAL RV ADVANTAGE!**

**SUPERIOR COACH BODY CONSTRUCTION**

National RV uses an advanced vacuum lamination process and the highest quality materials in the construction of the fully insulated roof, walls and floor.

**TUBULAR STEEL FRAME**

Stronger and less susceptible to work fatigue than aluminum and won't decay like wood.

**CROWNED ROOF**

The best RV roof in the business is built with arched tubular steel roof trusses. The crowned roof has radius edges for superior runoff.

**FIBERGLASS ROOF SKIN**

A seamless barrier against moisture; more durable and easier to maintain and repair than rubber or aluminum.

**¼" STRUCTURE-WOOD®**

This oriented strand board (OSB) from Weyerhaeuser carries a 25 year warranty and is used for both the roof deck and interior ceiling panel.

**EPS BLOCK FOAM INSULATION**

Used throughout the coach in every laminated coach body component. This foam won't settle or sag like spun fiberglass insulation. Insulation is up to 5½" thick in the roof, and completely surrounds the coach living areas. It's even in the floor!

**¼" THICK MAHOGANY INTERIOR WALL PANEL**

A thick, firm interior wall surface that's tough enough to anchor our cabinetry — and whatever pictures or fixtures you care to hang, wherever you want to hang them. Competitors' thin interior wall surfaces "give" when you push them, revealing their weakness beneath the surface, with reinforcements built in only where necessary to attach cabinets. Our interior wall surfaces are ¼" thick and rigid throughout!

**HIGH GLOSS GELCOAT EXTERIOR**

The exterior sidewall surface is made of a thick, resilient fiberglass gelcoat sheet that is vacuum laminated to the sidewall structure. The result is excellent resistance to delamination and long-lasting great looks.

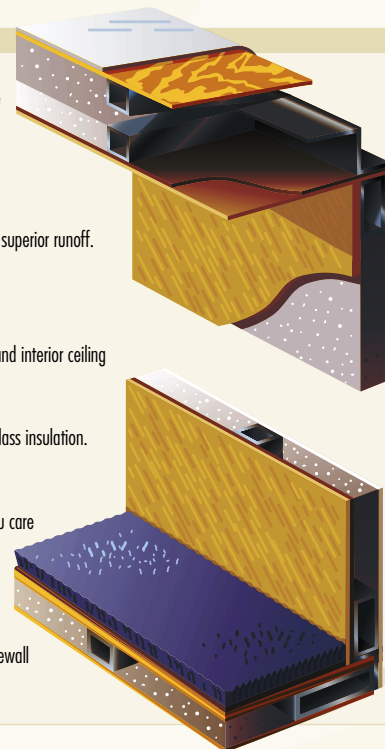

NOTE: Some components and their locations as shown in the photo above may differ slightly from the actual components of the chassis used in the Tropi-Cal LX. This photo is intended only as a general representation of the Duraframe Chassis System and is not intended to represent actual components and their locations.

# SPECIFICATIONS

## COACH BODY CONSTRUCTION

Duraframe® patented steel sub floor construction	S
Steel framed laminated floor	S
Steel framed crowned laminated fiberglass roof	S
Steel framed laminated fiberglass high gloss sidewalls	S
Custom painted three color full body exterior graphics with choice of (3) color packages	S
Front and rear molded high gloss fiberglass caps and integrated bumper assembly	S
Protective film front mask	O
Full width mud flap with logo	S
Padded vinyl ceiling material	S
Electric slide-out rooms	S
Insulated fiberglass exterior storage compartment doors with integrated paddle latches and gas struts	S
Dual directional slide-out storage compartment tray	O
Black aluminum rear ladder	S
Automotive undercoating	S
Steel insulated front bulkhead	S

## FURNITURE

Kustom Fit® soft touch Ultra-Leather® 6-way power recliner cockpit seats with swivel base; power footrest on passenger seat	S
Kustom Fit® Hide-A-Bed® fabric sleeper sofa with air mattress	S
Soft touch Ultra-Leather® Hide-A-Bed® sleeper sofa with air mattress	O
Kustom Fit® freestanding soft touch Ultra-Leather® Euro-recliner recliner with ottoman	S

## APPLIANCES & ACCESSORIES

27" flat screen TV in living area	S
20" flat screen TV with front A/V jacks in bedroom	S
Combination washer/dryer	O
Home theater entertainment package: Includes DVD/VCR digital receiver and speaker/subwoofer system	S
12 cu. ft. side-by-side refrigerator with ice maker	S
High output 3-burner cook top with flush mount Corian® range cover	S
21" conventional oven	O
Convection microwave oven with carousel, built-in light and fan	S
Cable TV hook-up and multiple telephone jacks	S
TV antenna	S
Kingdome® automatic stationary satellite dish	O

## COCKPIT FEATURES

Big button AM/FM cassette stereo and CD with four speakers	S
Multi-disc CD changer	S
Sirius® satellite radio module with 6 month subscription	S
Floormats	S
Color rear vision system with 3-cameras (1 rear, 2 side)	S
GPS navigation system	O
Pantographic windshield wipers	S
Two 2-speed dash fans	S
Power steering	S
Electronic cruise control	S
Douglas® tilt and telescoping steering wheel	S
Roof mounted dual chrome trumpet air horns	S
Chrome power controlled heated exterior mirrors with turn indicators	S
Hydraulic leveling jacks with dash mounted controls	S
Passenger workstation with 12V/120V receptacle and phone jack	S
Electric sunvisors	S
Keyless entry	S
Manual driver side sun shade	S
Electric stepwell cover	S
Wraparound privacy curtain with easy reach wand	S
Illuminated stepwell	S

## ELECTRICAL SYSTEMS

50 Amp 120V distribution panel	S
50 Amp detachable power cord and user-friendly exterior wall receptacle with chrome cover	S
12V push button circuit breaker distribution panel	S
Solar panel ready (pre-wired)	S
Onan® 8.0 KW Quiet Diesel generator	S
2,000 watt inverter/converter with remote on/off switch	S
(4) 6V deep cycle house batteries	S
(2) 760 CCA 12V maintenance-free chassis batteries	S
Systems monitor panel	S
Battery disconnect switch	S
Porch light	S
120V patio receptacle and telephone jack	S
Three water pump switches (kitchen, bathroom and exterior plumbing service station)	S
Courtesy light at entry-door switch panel	S
Fluorescent lights in ceiling with wall mounted switches	S
Pre-wired for trailer brake controller	S
Lights in exterior storage compartments	S



## INTERIOR

### Throughout

Natural Maple finish paneling and doors	S
Natural Cherry finish paneling and doors	O
Stained Cherry finish paneling and doors	O
Solid wood raised panel overhead cabinet doors in living area and bedroom	S
Drawers with ball bearing roller guide design	S

### Living Area

Plush carpet with deluxe pad	S
Hand laid ceramic tile flooring with designer accents	S
Day/night shades with designer valances	S
Booth dinette with slide-out storage baskets under seats	S
Dining table/cabinet with built-in table extension, two high-back wooden chairs and two wooden folding chairs	O

### Kitchen Area

Corian® kitchen counter top with stainless steel under-mount sink, Corian® sink covers and Corian® counter top extension (extension n/a on T391)	S
Slide-out pantry	S
Wastebasket	S
Rubbermaid® silverware organizer tray	S
Corian® backsplash with tile accents	S
Venetian blind and valance	S

### Bath Area

Corian® topped lavatory cabinet with stainless steel sink	S
Insulated skylight in shower	S

### Bedroom Area

Day/night shades with designer valances	S
Residential-style innerspring pillow top queen mattress (60" x 80")	S
Lift-up bed with under-bed storage compartment	S
Cedar lining in wardrobe and bed storage compartment	S
Wall dresser with drawers and laundry hamper (some models)	S
Rear dresser (replaces bay window seat, T391 only)	O

## WINDOWS, DOORS & AWNINGS

Insulated and tinted dual pane windows	S
Power double entrance step with light and anti-skid surface	S
Entrance door with driver-view (dogleg) clear glass window and screen door	S
Tinted skylight in bathroom	S
Ventilated windows on sides of slide-out rooms (lounge slides only)	S
Electric entry door awning with black hardware	S
Electric patio awning with black metal cover and hardware	S
Window awning package (living & bedroom) with black hardware	O
Slide-out topper awnings	S
Exterior windshield sun screens	O

## PLUMBING SYSTEMS

### Coach Exterior

Heated systems compartment with easy access to hook-ups	S
Manual dump valves	S
Pressurized water fill with regulator	S
On demand water system and water pump	S
Water heater bypass valve	S
Winterization antifreeze inlet to pump	S
Holding tank rinsing system (black tank only)	S
Outside shower	S

### Kitchen Area

Water filter/faucet in kitchen	S
Single lever faucet with detachable gooseneck sprayer	S

### Bath Area

Porcelain toilet with sprayer	S
Designer glass shower enclosure	S
One piece fiberglass shower	S
Single lever lavatory faucet	S
10 gallon, quick-recovery water heater with direct spark ignition (gas/electric)	S
Pre-plumbed for optional washer/dryer	S

## SAFETY FEATURES

Fire extinguisher	S
Deadbolt lock on entrance door	S
120V GFI protected circuits (kitchen, bath and exterior)	S
Smoke, carbon monoxide (CO) and LPG detectors	S
Driver and passenger three point seatbelts	S
Emergency exit window	S
Deluxe acrylic exterior assist handle	S
Full height interior entry assist handle	S
Hand activated ICC flasher switch (momentary) on side console	S

## CLIMATE CONTROL

Dual 13,500 BTU Duo-Therm® low profile Penguin® air conditioners with heat pump	S
Dash automotive heating and air conditioner system with defroster	S
Dual in-ceiling insulated A/C ducts	S
Dual 20,000 BTU furnaces	S
12V Fan-Tastic® vent in living area with thermostat & rain sensor	S
12V roof exhaust fan in rear	S
12V Fan-Tastic® vent in rear with thermostat & rain sensor	O

**S** = Standard Equipment  
**O** = Optional Equipment

NOTE: Colors, equipment and specifications depicted in this brochure are subject to change without notice. Please verify the actual equipment installed on any specific motorhome prior to purchase.

Left: T391 • Sydney • Natural Maple

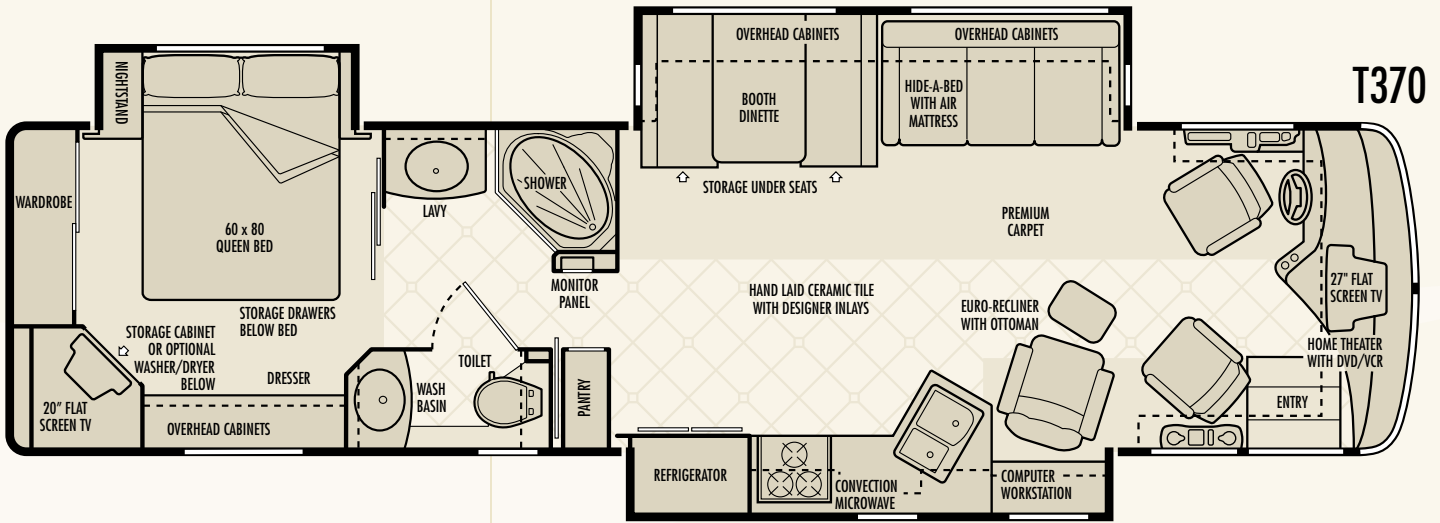
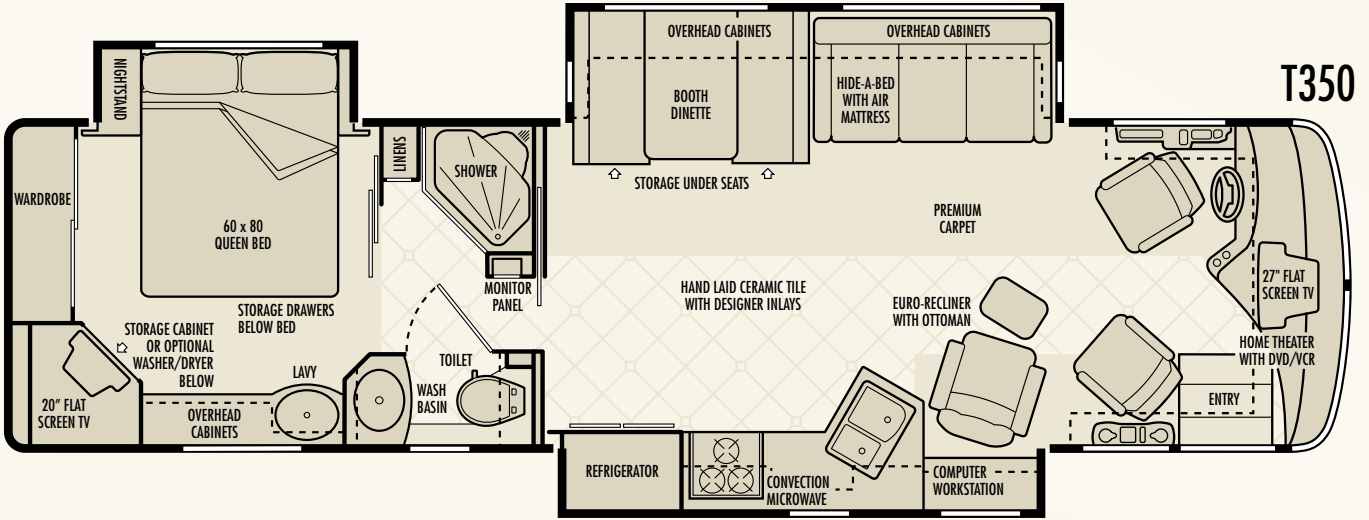

## Wide Open Spaces

WEIGHTS & MEASUREMENTS	T350	T370	T391
Gross Vehicle Weight Rating (lbs.)	28,000	28,000	30,500
Gross Combined Weight Rating (lbs.)	38,000	38,000	40,500
Front Gross Axle Rating (lbs.)	10,500	10,500	10,500
Rear Gross Axle Rating (lbs.)	17,500	17,500	20,000
Wheelbase	208"	228"	252"
Overall Length	35' 5"	37' 1"	39' 1"
Overall Height (add 7" for sat. dish)	12' 1"	12' 1"	12' 1"
Interior Height	6' 7½"	6' 7½"	6' 7½"
Interior Width	98"	98"	98"
Exterior Width	102"	102"	102"
Water Heater (gallons)	10	10	10
Fresh Water (gallons)	105	105	105
Gray Tank (gallons)	60	60	60
Black Tank (gallons)	40	40	40
LP-Gas (liquid volume, gallons)	47.7	47.7	47.7

NOTE: Colors, equipment and specifications depicted in this brochure are subject to change without notice.

**OPTIONAL DINING  
TABLE & CHAIRS  
(ALL FLOORPLANS)**

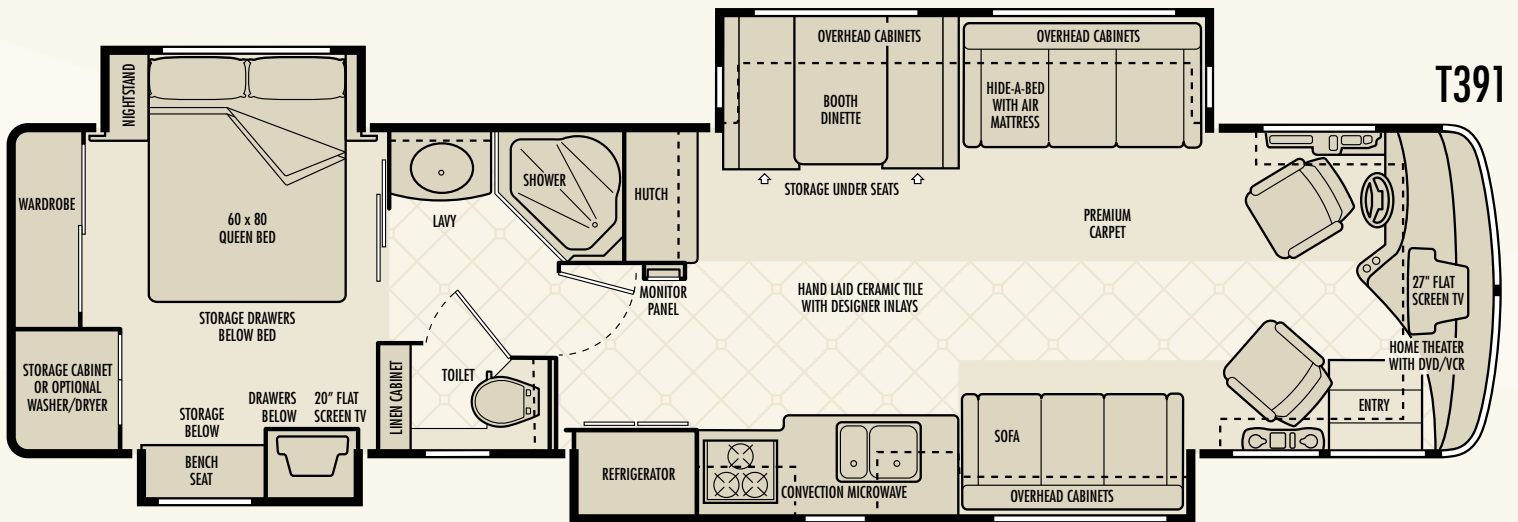
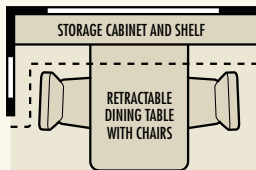

**T391**

Below: T370 • Dakkar • Natural Cherry



**✓ ANOTHER NATIONAL RV ADVANTAGE!**

**KUSTOM-FIT® SEATING**

Built especially for National RV, this cockpit and living area seating exceeds the comfort and quality of furniture in much more expensive "highline" motorhomes. The foam of each seat cushion is *cold poured* as a single piece, molded in the correct shape. Competitors' seats are pieced together from blocks of foam which can come unglued and fall apart. This seat foam is so durable it carries a 10 year warranty. The rugged seat frame is constructed of welded tubular steel for superior strength and carries a lifetime warranty.



**WOOD FINISHES INTERIOR DECORS**

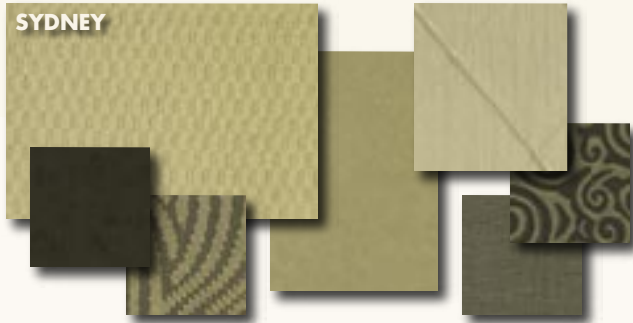
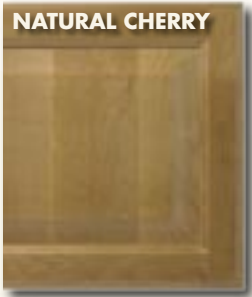

**EXTERIORS**



*2007 Tropi-Cal LX*



**NATIONAL R.V., INC.**  
 3411 N. Perris Boulevard  
 Perris, California 92571  
 (800) 322-6007 • Fax (951) 943-8498  
**www.nationalrv.com**

©2006 National R.V., Inc. Colors, equipment and specifications depicted in this brochure are subject to change without notice. Please verify the actual equipment installed on any specific motorhome prior to purchase.

TRLX07V1 • AUG 06



National RV, Inc. is a subsidiary of National RV Holdings, Inc., a public company whose shares are traded on the New York Stock Exchange under the symbol **NVH**. Please see **www.nrvh.com** for more information.



YOUR AUTHORIZED TROPI-CAL LX DEALER IS: