



SIMBA™ 2005

Live out loud.





## LIFE IN THE FUN LANE

For 2005, we're celebrating the return of the Simba. This value-packed motorhome combines all the convenience of gas power with many stylish features. You'll enjoy an outstanding interior decor package, including beautiful cabinets with woven raffia inserts, decorative wall art, sculptured headboard, a flatscreen TV and many more residential details. And most importantly, the 2005 Simba has a 32 percent increase in storage space from last year's edition, including new pass-through storage bays with easy-to-clean rotocast boxes and convenient new side-hinged baggage doors. In short, if you're ready for adventure Safari-style, this is a great place to start.

**Black Slate**



**Ruby Canyon**



**Spice Route**

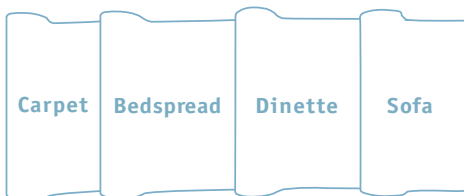

**BETTER  
STAIN  
PROTECTION**

Manufactured in, not added on. For added protection against stains, Dupont Teflon® soil repellent is applied to virtually all upholstery fabric during the finishing process for superior coverage.\*

\* Brand and application of upholstery fabric protection may vary depending on date recreational vehicle was manufactured.



Black Slate



Ruby Canyon



Spice Route

Vintage Oak (Standard)



Autumn Cherry (Option)





Maple (Option)



# SIMBA FLOORPLANS

**Safari craftsmanship.** At Safari, we're always giving you more of what you want in a coach — and less of last year's thinking. Take our floorplans. They come straight to you from the drawing board — they're livable, up-to-date and loaded with options. The 2005 Simba offers six imaginative floorplans from which to choose, including double and triple slide-outs, as well as a bath-and-a-half model.



Carpet —  Linoleum —  Plank — 

**33 PBD**

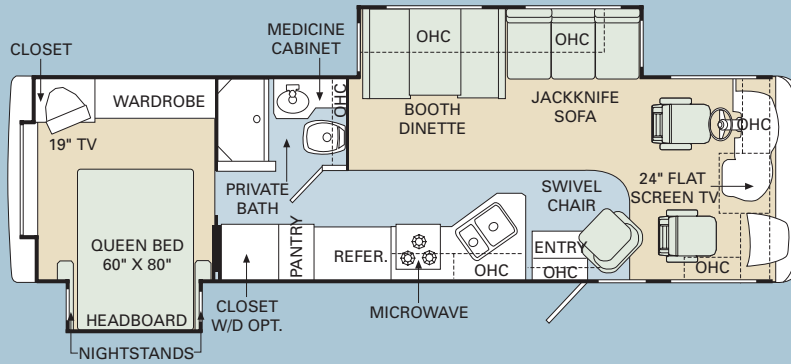

**34 SBD**

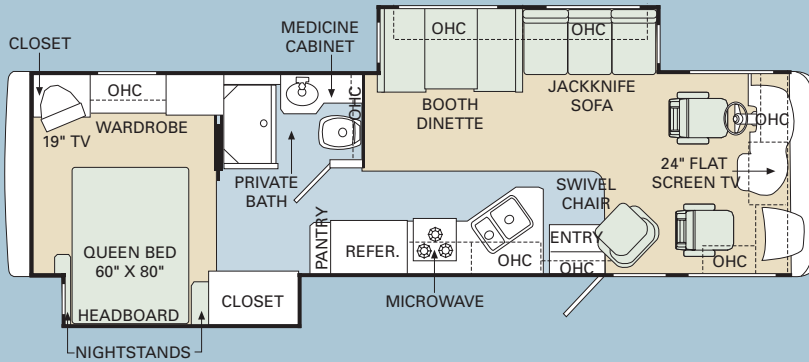

**36 WDD**

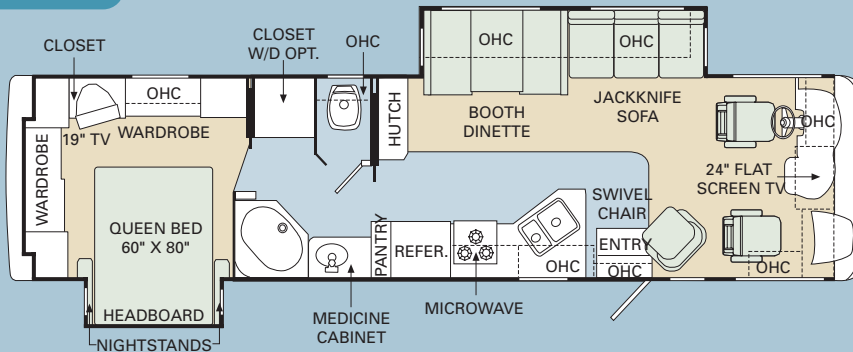

Carpet — Linoleum — Plank

36DBD

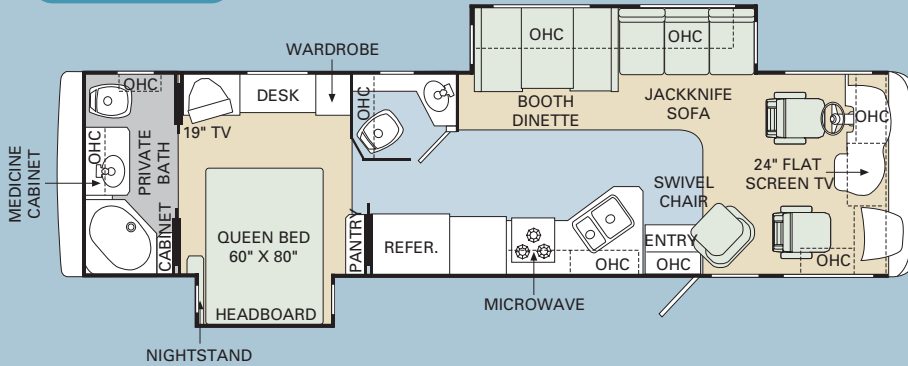

37PBD

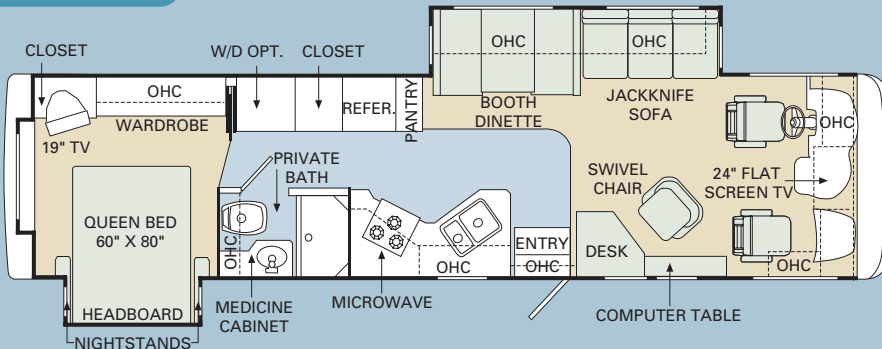

37PCT

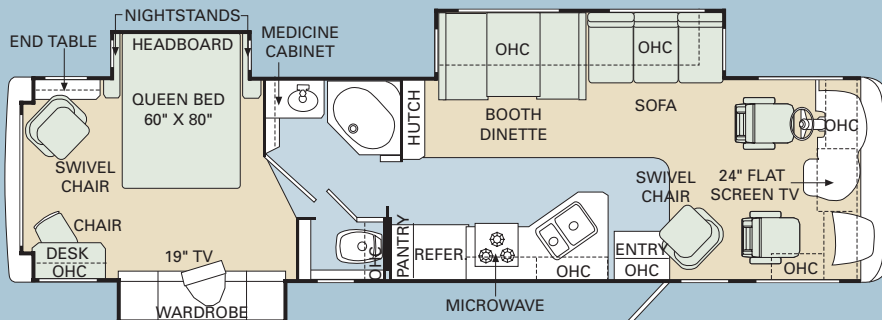

## Body Construction

### Standard Features

Alumaframe® Superstructure  
 Steel Cage Cockpit Construction  
 Peaked Aluminum Roof with Fiberglass Insulation  
 Smooth Aluminum Exterior Walls  
 Front and Rear Molded Fiberglass Caps  
 Chrome Insert around Taillight Area  
 Aluminum Framed Floor on Steel Trusses  
 Laminated Structurwood™ Flooring  
 Interior Paneling with 3/4" Insulation  
 Foam Insulated Floor Framing with 3-Ply Underbelly  
 One-Piece Engine Cover  
 Power Heated Remote Exterior Mirrors, Taller with Bottom Convex  
 Headlamps with Turn Signals  
 Fog Lights

Pass-Through Storage Bays under Slide-Outs with New Rotocast Boxes, 32% Increased Storage over 2004  
 Side-Hinged Baggage Doors, All Opening Doors between Front and Rear Tires (Where Applicable)  
 One-Piece Polyethylene Storage Compartment  
 Wheel Mud Flaps  
 Integrated Metal Fuel Door with Lock  
 Painted Mask and Skirt with Vinyl Exterior Graphics  
 Rear Ladder  
 Interior Rubber Entry Step  
 Exterior Triple Entry Steps All Floorplans (N/A: 30PDD)  
 Undercoating

### Options

Smooth Gel Coat Fiberglass Exterior Walls  
 Full-Length Mud Flap

## Ford Chassis, Engine & Suspension

### Standard Features

6.8L V-10 Gasoline Engine with Electronic Fuel Injection  
 Engine Displacement: 6.8L/415 Cu. In.  
 Power: 310 HP; Torque: 425 lbs./ft.  
 4-Speed Automatic Transmission with Overdrive  
 Fuel Tank Capacity: 75 Gallon  
 130 Amp Alternator  
 Rear Axle Ratio: 5.38:1  
 Radial Tires: 235/80R 22.5G  
 Polished Aluminum Wheels

Leaf Spring Suspension  
 ABS Brake System  
 Hitch Receiver with Dual Connector, 4-Pin or 7-Pin: 4,000 Lbs.  
 SmartStructure II

### Options

Fully Automatic Hydraulic Leveling System

## Workhorse Chassis, Engine & Suspension

### Standard Features

8.1L V-8 Gasoline Engine with Electronic Fuel Injection  
 Engine Displacement: 8.1L/496 Cu. In.  
 Power: 340 HP; Torque: 455 lbs./ft.  
 5-Speed Automatic Transmission with Overdrive  
 Fuel Tank Capacity: 75 Gallon  
 145 Amp Alternator  
 Rear Axle Ratio: 5.38:1  
 Radial Tires: 235/80R 22.5G  
 Stainless Steel Wheel Liners

Leaf Spring Suspension  
 ABS Brake System  
 Hitch Receiver with Dual Connector, 4-Pin or 7-Pin: 4,000 Lbs.  
 SmartStructure II

### Options

Fully Automatic Hydraulic Leveling System

## Cockpit

### Standard Features

Fiberglass Automotive Dash with Roman Bronze Instrument Panel and Two-Tone Dash Vinyl  
 CD Player/Radio with Four Speakers  
 Multi-Positioned Sunvisors  
 Pleated Front Privacy Drape with Braided Tie Backs  
 Rear Vision System Prep  
 Intermittent Windshield Wipers  
 Tilt Steering Wheel  
 Cruise Control  
 Power Steering  
 Electric Automotive Horn  
 Redesigned Wood Center Console on Engine Cover, Recess Tray with Rubber Mat, and Plastic Two-Tier Cup Holders, Front Tip-Door Ford/Front Drawer Workhorse Chassis  
 Two-Tier Side Cup Holder for Pilot Seat (N/A with Door Option)  
 Two-Tier Side Cup Holder for Co-Pilot Seat with Magazine Rack Below  
 Soft Touch Vinyl Pilot and Co-Pilot Recliner Seats

Carpeted Driver and Passenger Floor Mats  
 Dash Workstation  
 Wood Framed Cabinet Doors with Smoked Glass over Front Entertainment Center Systems  
 Secure Front Cab over TVs with Steel Framing

### Options

Six-Way Power Pilot Seat  
 Six-Way Power Co-Pilot Seat  
 Rear Vision System with Audio and Adjustable Camera  
 3-Camera Rear Vision System with Audio and Adjustable Center Camera  
 Pilot and Co-Pilot Pull-Down Sunshades  
 CB Radio Prep  
 Driver's Side Door with Power Window  
 Cassette Radio Option Includes AM/FM Tuner, CD Player, Weather Band

## Appliances & Accessories

### Standard Features

Large Double-Door Refrigerator  
 High-Output 3-Burner Cooktop without Oven  
 Bi-Fold Range Cover  
 Spacesaver Microwave with Touch Control  
 24" Flatscreen Stereo Color TV with Remote Control in Living Area  
 19" Stereo Color TV with Remote Control in Bedroom

TV Antenna  
 VCR Prep and Video Control Box with Booster  
 Exterior Hook-Ups for DSS Dish and Cable  
 Interior Cable TV Hook-Up and Telephone Jacks  
 Digital Satellite System Prep  
 Exterior Gas Line Hook-Up Prep for LP Accessories

### Options

Large Double-Door Refrigerator with Ice Maker, 8 Cu. Ft.  
 Large Double-Door Refrigerator with Ice Maker, 10 Cu. Ft.  
 Large Four-Door Refrigerator with Ice Maker (N/A with Pantry)  
 High-Output Three-Burner Range with Oven  
 Spacesaver Convection Microwave with Touch Control  
 Washer/Dryer Prep, Requires 50 Amp Service Option (N/A: 34SBD, 37PCT)

Combination Washer/Dryer (Requires Washer/Dryer Prep Option) (N/A: 34SBD, 37PCT)  
 Stereo TV Wired through Ceiling Speakers  
 VCR  
 DVD Player (N/A with Home Theater Option)  
 Home Theater System with DVD Player and Surround Sound Speakers  
 Exterior Entertainment Center, CD Player Radio with Two Speakers

## Interior

### Standard Features

- Vintage Oak Cabinetry
- Upper Cabinet Doors with Single Oval Arch, with Woven Raffia Insert, Cockpit Side Cabinet Doors with Square Panel with Woven Raffia Insert, Flat Panel Doors on Base Cabinets and Wardrobes
- Cabinet End Panels
- Black ABS Refrigerator Insert
- Decorative Wallboard
- Wallpaper Border Kitchen, Bath and Bedroom Walls
- Self-Supporting Top-Hinged Overhead Storage Doors and Positive Catches on All Other Doors
- Heavy-Duty Ball Bearing Drawer Guides
- Wood Cabinet Drawer Boxes
- Wood Interior Grab Handle on Cabinet at Entry Door
- Long Interior Grab Handle at Entry Door
- Antique Brass Cabinetry Hardware and Bath Accessories
- Integrated Cup Holder to Slide-Out next to Sofa
- Laminate Kitchen Countertop with Perm-Edge and Stainless Steel Sink, Chrome Pullout Faucet and Two Sink Covers
- Toe Kicks, Kitchen and Bath Base Cabinets
- Laminate Bathroom Countertop with Laminate Perm-Edge
- All Other Countertops are Laminate with Perm-Edge
- Kitchen Overhead Cabinets with Adjustable Shelf
- Kitchen Pantry next to Refrigerator with Adjustable Shelves in Upper Cabinet and Three Drawers Below (N/A with Four-Door Refrigerator Option)
- Silverware Drawer with Organizer Kitchen Base Cabinets (N/A with Range Option)
- Trash Can in Kitchen Base Cabinet
- Mirrors above Kitchen Backsplash
- Linoleum Flooring Kitchen, Flooring to Include Entry Door
- Linoleum Flooring in Center Bathroom
- Plank Flooring in Rear Bath (36DBD)
- Upgraded Nylon Carpeting with Pad in Living Area and Bedroom
- Soft Touch Padded Vinyl Ceiling
- Wood Slide-Out Fascia with Vinyl Inserts
- Picture next to Dinette Area or Bedroom, Wainscoting Accent under Picture Dinette Area (37PCT Bedroom)
- Second Picture, Bedroom Area (N/A: 36DBD, 37PCT)
- Hutch with Glass Doors/Backlighted Glass (36WDD, 37PCT)
- Bath Door with Accent Trim on Hallway Side, with Woven Raffia Inserts
- Wood Trim on Bath Door Opening Hallway Side
- Wood Louvers on Washer and Dryer Doors (N/A: 34SBD, 37PCT)
- Magazine Rack Bathroom (NA: 33PBD, 34SBD)
- Wood Grain Crown Molding in Bedroom and Living Area on All Open Walls
- Medicine Cabinet with Shelves
- Bathroom Lavatory Base Mirror with Wood Frame
- Antique Brass, Towel Bar on Back of Bath Door, Towel Bar in Rear Bath across from Shower (36DBD)
- Antique Brass Two Towel Rings in Bathroom
- Accent Mirror on Rear Wall with Chair Rail and Wainscoting Accent under Mirrors (34SBD)
- Chair Rail and Wainscoting on Rear Wall (33PBD, 37PBD)
- Rear Wardrobe Closet with Deluxe Mirror Door Frames, Antique Brass Finish (36WDD)
- Side Wardrobe Closet with Deluxe Mirror Door Frames Antique Brass Finish (33PBD, 37PBD)
- Bedroom Swing-Away TV Cabinets
- Bedsread with Two Decorative Pillows
- Decorative Wood Grain Headboard
- Blackout Day/Night Pleated Shades in Living Area and in Bedroom
- Mini Blinds in Kitchen and Bathroom (Where Applicable)
- Soil Repellant on Fabric, Teflon® Fabric Protection

### Options

- New Decors: Ruby Canyon, Spice Route, Black Slate
- Wood Choice: Autumn Cherry and Maple
- Woven Raffia Panel Doors on Refrigerator



## Furniture

### Standard Features

Queen Bed with Nightstands  
 Arched Back Wood Booth Dinette with Side-Sliding Table Top and Drawers  
 Fabric Jackknife Sofa, Two Pillows on All Sofas

Fabric Swivel Glider Barrel Chair  
 Fabric Swivel Glider Barrel Chair and Desk Chair Bedroom (37PCT)

### Options

Fabric Hide-A-Bed Sofa with Two Pillows  
 Fabric Hide-A-Bed Sofa with Air Mattress and Two Pillows  
 Soft Touch Vinyl Hide-A-Bed Sofa with Two Pillows  
 Soft Touch Vinyl Hide-A-Bed Sofa with Air Mattress and Two Pillows  
 Curbside Sofa Touch Vinyl J-Lounge IPO Swivel Glider Barrel Chair and Computer Desk (37PBD)  
 Fabric Electric Sofa IPO Jackknife Sofa  
 Fabric Swivel Recliner Chair IPO Fabric Swivel Glider Barrel Chair  
 Soft Touch Vinyl Swivel Recliner Chair IPO Fabric Swivel Glider Barrel Chair

Fabric Swivel Glider Barrel Chair IPO Desk Chair Bedroom (37PCT)  
 Curbside Two Fabric Recliners IPO Swivel Glider Barrel Chair and Computer Desk (37PBD)  
 Curbside Two Soft Touch Vinyl Recliners IPO Swivel Glider Barrel Chair and Computer Desk (37PBD)  
 Bedroom Desk (34SBD, 36WDD, 36DBD)  
 Adjustable Coffee Table  
 Freestanding Round Dinette Table with Two Chairs and Longer Windows IPO Booth Dinette  
 Two Extra Folding Freestanding Dinette Chairs

## Electrical Systems & Lights

### Standard Features

30 Amp 120V Distribution Panel and Power Cord  
 55 Amp Electronic 12V Power Converter  
 Onan® 5.5 kW Gas Generator  
 Two 6V House Batteries  
 Battery Disconnect Switches  
 12V and 110V Outlet in Cockpit Area  
 Porch Light and Exterior Step Light on Same Switch  
 Exterior Power Entry Step with Light  
 Interior Stepwell Entry Step Lights  
 Water Pump Switch in Service Bay Area and Interior Systems Panel  
 Lights in Outside Storage Compartments  
 120V Receptacles in Outside Storage Compartment  
 Underhood Utility Light  
 Receptacle and Phone Jack in Dinette Area  
 Directional Map Lights Pilot and Co-Pilot Seats  
 Systems Control Center in Hallway  
 Fluorescent Light(s) with Night Light Function under Kitchen Overhead

Fluorescent Ceiling Lights Living Area  
 Fluorescent Ceiling Lights inside Living Area inside Slide-Out House  
 12V Incandescent Ceiling Lights Bath, Hallway and Bedroom  
 Decorative Wood Framed Galley Ceiling Fluorescent Light with Skylight and Shade  
 Decorative Antique Brass Finish Lighting Living Room Wall Light, Dinette Overhead, Cosmetic Vanity Light  
 Halogen Lights under Living Room and Dining Room Overhead Cabinets  
 Reading Lights over Bed – Black Finish with His and Her Switches on Each Side above Nightstands

### Options

Energy Management System with or without 50 Amp Service  
 50 Amp 120V Distribution Panel and Cord  
 130 Watt Inverter  
 Fluorescent Ceiling Lights Bath, Hallway and Bedroom  
 Storage Compartment Tank Monitor Gauge

## Plumbing & LP Systems

### Standard Features

Kitchen Stainless Steel Sink with Single Lever Chrome Pullout Faucet  
 Separate Chrome Faucet for Filtered Water  
 Bath Lavatory Faucet Single Handle Antique Brass Finish  
 Demand Water System and Water Pump  
 10 Gallon LP Gas/Electric Water Heater with Electronic Ignition, DSI  
 Winterization Valving System  
 Water Heater Bypass Valve  
 Toilet with Sprayer  
 No-Fuss Flush Holding Tank Rinsing System  
 Insulated Systems Compartment with Easy Access to Hookup

Shower inside Wet Bay with Hot/Cold Water  
 Soap Dispenser inside Utility Bay  
 Gravity and Pressurized Water Fill  
 Contained Storage Area for Sewer Hose  
 One-Piece Fiberglass Shower  
 Shower Diverter, Hose and Head, Antique Brass Finish with Slide Bar for Shower Head with Soap Dish  
 Shower Light on Ceiling inside Shower  
 Antique Brass Shower Door Frame with Decorative Glass

### Options

RV Sani-Con 2 System, Holding Tank Flush System  
 Bathtub Option IPO Shower

## Heating, Vents & Air Conditioning

### Standard Features

One 13.5M BTU Air Conditioner with Ducted Air and Analog Wall Thermostat, Low-Profile Ford and Workhorse (33PBD, 34SBD)  
 One 13.5M BTU and One 11.0M BTU Air Conditioner with Ducted Air and Wall Analog Thermostat, Low-Profile Ford and Workhorse (N/A: 33PBS, 34SBD)  
 35M BTU Electronic Ignition Furnace  
 Electronic Dash Air Conditioner/Heat Climate Control System  
 In-Floor Ducted Heating System with Metal Floor Registers  
 Manual Roof Vent Kitchen (N/A: 33PBD, 34SBD)  
 Manual Roof Vent Living Area (33PBD, 34SBD)  
 12V Roof Vent Bathroom  
 Manual Roof Vent Bedroom (33PBD, 34SBD)  
 12V Heater in Wet Bay, Heat Pad on Fresh Tank (N/A: 36DBD)  
 Metal Air Return Grill Furnace Antique Brass Finish  
 Metal Floor Registers Antique Brass

### Options

Dual 13.5M BTU Air Conditioner (Requires 50 Amp Service), Low-Profile Ford and Workhorse (N/A: 33PBD, 34SBD)  
 One 13.5M BTU and One 11.0M BTU Air Conditioner, Low-Profile Ford and Workhorse (33PBD, 34SBD)  
 Dual 13.5M BTU Air Conditioner with Heat Pumps, (Requires 50 Amp Service), Low-Profile Ford and Workhorse  
 One 13.5M BTU Air Conditioner with Heat Pump, Kitchen (N/A with Twin Air Conditioner), Low-Profile Ford and Workhorse (33PBD, 34SBD)  
 12V Attic Fan Kitchen (N/A with Single Air Conditioner)  
 12V Attic Fan Living Area (N/A with Twin Air Conditioners)

## Windows, Doors & Awnings

### Standard Features

Radius Flush-Mount Dual-Pane Windows Safety Glass  
 Dark Tinted  
 Opera Window at Swivel Glider Barrel Chair Location  
 Rear Wall Bedroom Window (33PBD, 37PBD, 37PCT)  
 Bathroom Window (36WDD, 36DBD, 37PCT)  
 Radius Entrance Door with Clear Glass, Roller Shade,  
 Screen Door and Anti-Skid Steps  
 Two Interior Grab Handles and One Exterior Grab Handle  
 Topper Slide-Out Awnings Living Area and Bedroom  
 Protecta Glaze Tinted Plexiglas® Skylight in Kitchen  
 with Pleated Shade

Protecta Glaze Tinted Plexiglas® Skylight in Bathroom  
 Awning Rail

### Options

Acrylic Patio Awning with Metal Cover  
 Eclipse Automatic Patio Awning  
 Acrylic Window Awnings Living Area Slide-Out  
 House Windows  
 Acrylic Side Window Awning Bedroom (N/A: 37PCT)

## Safety

### Standard Features

Fire Extinguisher  
 Deadbolt Lock on Entrance Door  
 120V GFI Protected Circuit, Kitchen, Bath and Exterior  
 LP Gas Detector  
 Smoke Detector

Carbon Monoxide Detector  
 Pilot and Co-Pilot Three-Point Seat Belts  
 Third Brake Safety Light  
 Egress Windows

www.motorcoaches.com

*Visit our website for the  
 latest Safari news, product  
 details, rally information  
 and much more.*

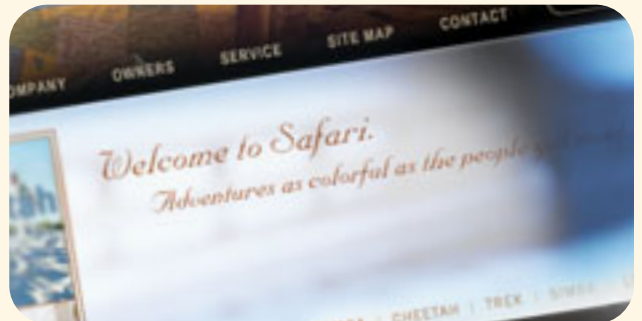



# weights & measurements

FORD Weight Rating (Lbs.)	33PBD	34SBD	36WDD	36DBD	37PBD	37PCT
Gross Vehicle Weight Rating	22,000	22,000	22,000	22,000	22,000	22,000
Gross Combined Weight Rating*	25,500	25,500	25,500	25,500	25,500	25,500
Front Gross Axle Weight Rating	7,500	7,500	7,500	7,500	7,500	7,500
Rear Gross Axle Weight Rating	13,500	13,500	13,500	13,500	13,500	13,500
<b>WORKHORSE Weights W-22 (Lbs.)</b>						
Gross Vehicle Weight Rating	22,000	22,000	22,000	22,000	22,000	22,000
Gross Combined Weight Rating*	26,000	26,000	26,000	26,000	26,000	26,000
Front Gross Axle Weight Rating	8,000	8,000	8,000	8,000	8,000	8,000
Rear Gross Axle Weight Rating	14,500	14,500	14,500	14,500	14,500	14,500
<b>Measurements</b>						
Wheelbase	228"	228"	242"	242"	242"	242"
Overall Length	32' 7"	34' 10"	36' 6"	36' 6"	36' 11"	36' 11"
Overall Height, Including A/C, Ford	11' 9"	11' 9"	11' 9"	11' 9"	11' 9"	11' 9"
Overall Height, Including A/C, Workhorse	12' 0"	12' 0"	12' 0"	12' 0"	12' 0"	12' 0"
Interior Height	6' 6"	6' 6"	6' 6"	6' 6"	6' 6"	6' 6"
Interior Width	94.5"	94.5"	94.5"	94.5"	94.5"	94.5"
Exterior Width	100.5"	100.5"	100.5"	100.5"	100.5"	100.5"
<b>Tank Capacities** (Gal.)</b>						
Water Heater	10	10	10	10	10	10
Gray Tank	45	40	54	42/39	45	45
Black Tank	54	42	45	42/39	54	54
Fresh Tank	60	60	60	60	60	60
LP Tank ***	24	24	24	24	24	24
Fuel Tank	100	100	100	100	100	100
<p>* Towing capacity is limited by GCWR; your vehicle's towing capacity is the difference between the GCWR and the actual vehicle weight, including all water, fuel, passengers and cargo. Your towed vehicle should be equipped with auxiliary brakes if the weight of the towed vehicle exceeds 1,000 lbs. Consult your Owner's Manual for further towing information.</p> <p>** All tank capacities are estimated based upon calculations provided by the tank manufacturers and represent approximate capacities. The actual "usable capacity" may be greater or less than the estimated capacities based upon fabrication and installation of the tanks.</p> <p>*** Actual filled LP capacity is 80% of listing due to safety shut-off required on tank.</p>						

Due to the large variety of options and floorplan arrangements available to our customers, actual weights for each unit can differ significantly. Safari provides a weight sticker on each unit we produce which includes that unit's tank capacities and approximate weight. Consult your local Safari dealer for unit availability and further information. The information printed in this brochure reflects product design, fabrication, and component parts at the date of printing. The manufacturer reserves the right, at any time, to make changes in product design or material or component specifications as its sole option, without notice. This includes the substitution of components of a different brand or trade name, which will result in comparable performance. All information printed in this brochure is subject to change after the date of printing. Some features shown or mentioned in this brochure are optional and may only be available in selected floorplans. Photographs may show props or decorations that are not standard equipment on Safari models. Safari, the Safari logo and its design, are registered trademarks. All other products and company names are trademarks and/or registered trademarks of their respective holders.

While the color of the motorhome's exterior and the interior fabrics depicted in this sales brochure are fair and reasonable depictions, the colors depicted may not be an exact match of the actual colors because of the variances in photo-processing and variances caused by inserting the photographs within the sales brochure. Due to product improvements, changes during the model year and/or transcription errors that may occur, information represented within this brochure may not be accurate at the time of your purchase. If certain information is significant to your purchasing decision, please confirm the information with your dealer prior to submitting your order.

The actual overall length of the recreational vehicle may differ from that indicated in the brochure due to variances in the manufacturing process and/or installed components. The actual length may be greater or less than that indicated.